

Front bumper → (Audi RS6)

Assembly overview

1 - Air inlet grille

- ◆ To remove pull grille forward

2 - Air inlet grille

- ◆ To remove pull grille forward

3 - Screw

- ◆ 2.5 Nm
- ◆ 3x

4 - Bumper cover

- ◆ Together with impact absorber, removing and installing ⇒ [Page 63-6](#)
- ◆ Cross member from bumper cover removing and installing ⇒ [Page 63-16](#)

5 - Screws

◆ 2.5 Nm
(22 in.
lb)

◆ 3x

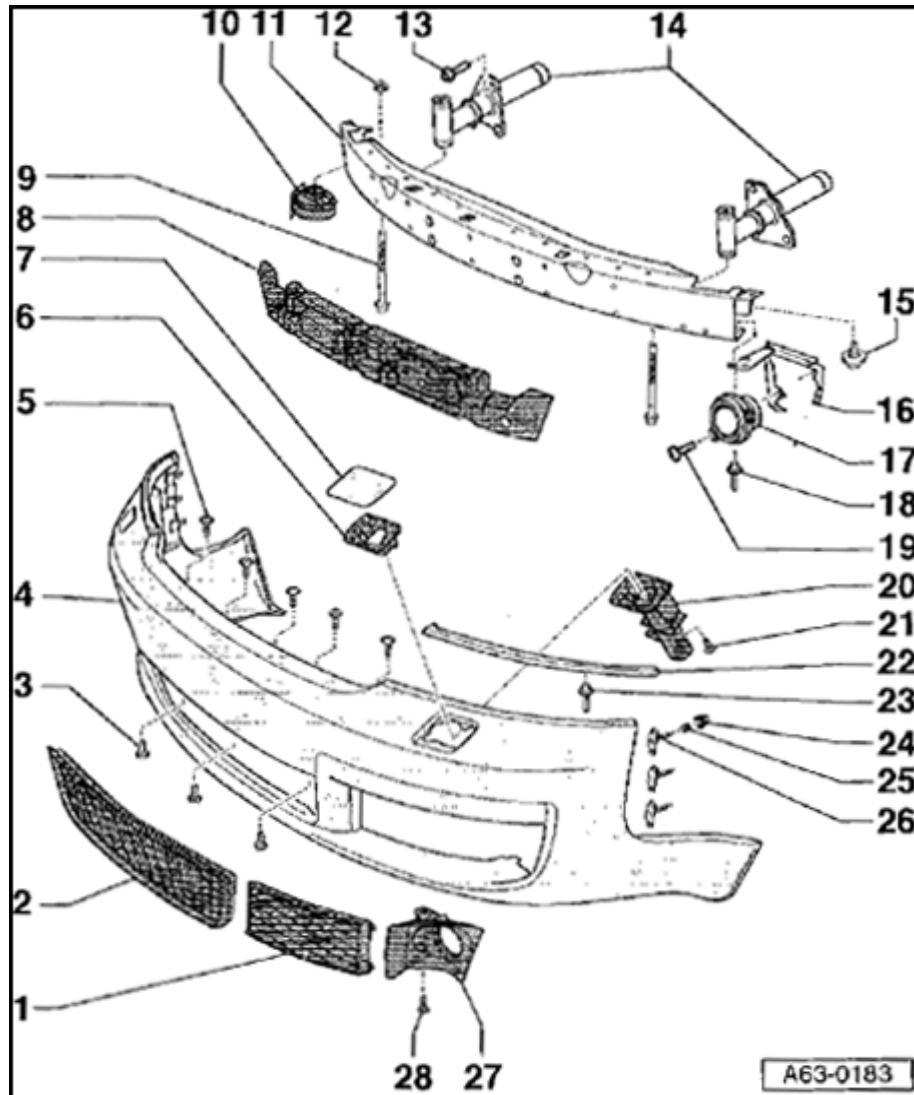
**6 - Retainer**

- ◆ For headlight washer nozzle

7 - Lid

- ◆ For headlight washer nozzle

8 - Impact absorber**9 - Socket head bolt**

- ◆ 23 Nm (17 ft. lb)

- ◆ 2x

- ◆ Install after bumper installation

- ◆ Height adjustment to cross member is self-compensating
⇒ [Page 63-13](#)

10 - Horn**11 - Cross member**

- ◆ From bumper cover, removing and installing
⇒ [Page 63-16](#)

12 - Nut

- ◆ 11 Nm (8 ft.lb)

13 - Bolt

◆ 50 Nm
(36 ft.
lb)

◆ 6x

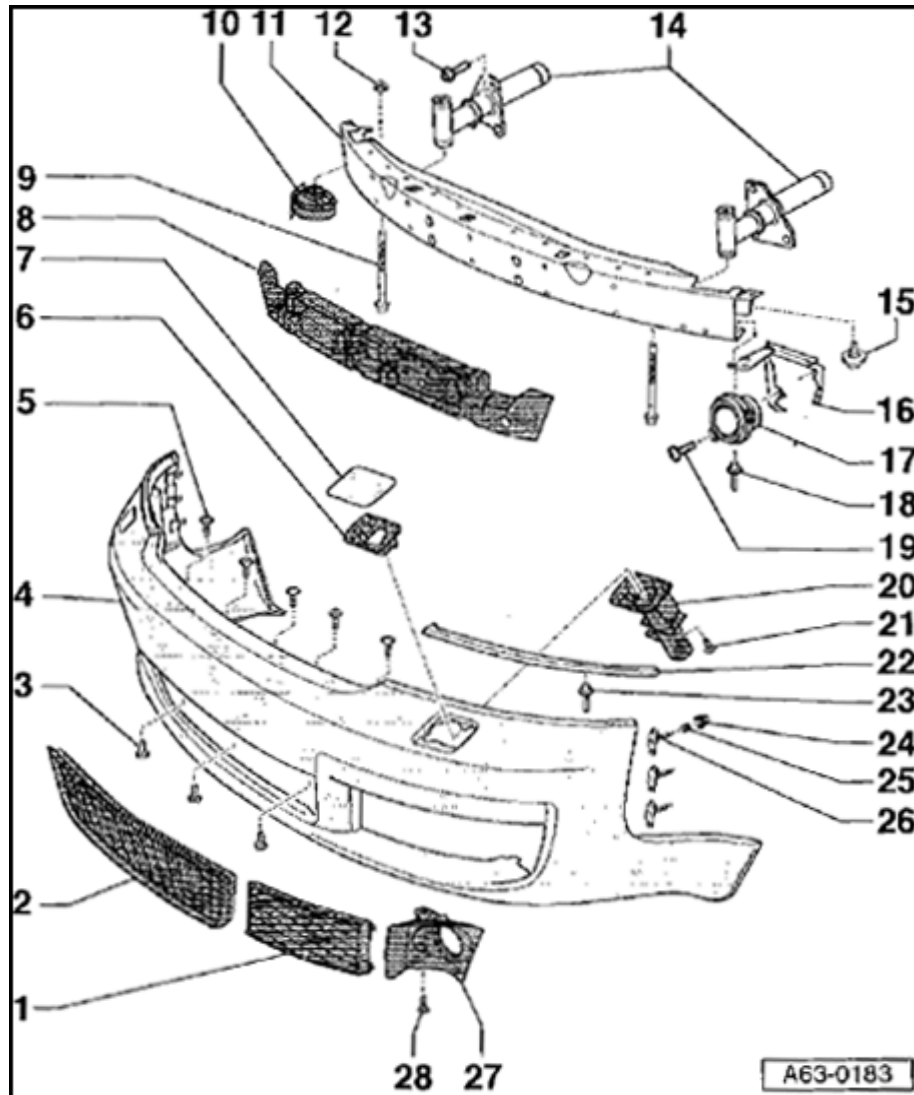

14 - Impact absorber

- ◆ Removal and installation
⇒ [Page 63-20](#)

15 - Torx® bolt

- ◆ 1.5 Nm (13 in. lb)
- ◆ 2x

16 - Bracket

- ◆ For fog light

17 - Fog light

- ◆ Removing and installing

⇒ *Repair Manual; Electrical Equipment; Lights, switches - Exterior, Repair Group 94*

18 - Rivet

- ◆ 12x

19 - Torx® bolt

- ◆ 4 Nm (3 ft. lb)
- ◆ 4x

20 - Headlight washer nozzle assembly

- ◆ For headlight cleaning

21 - Torx® bolt

◆ 25 Nm
(18 ft.
lb)

◆ 4x

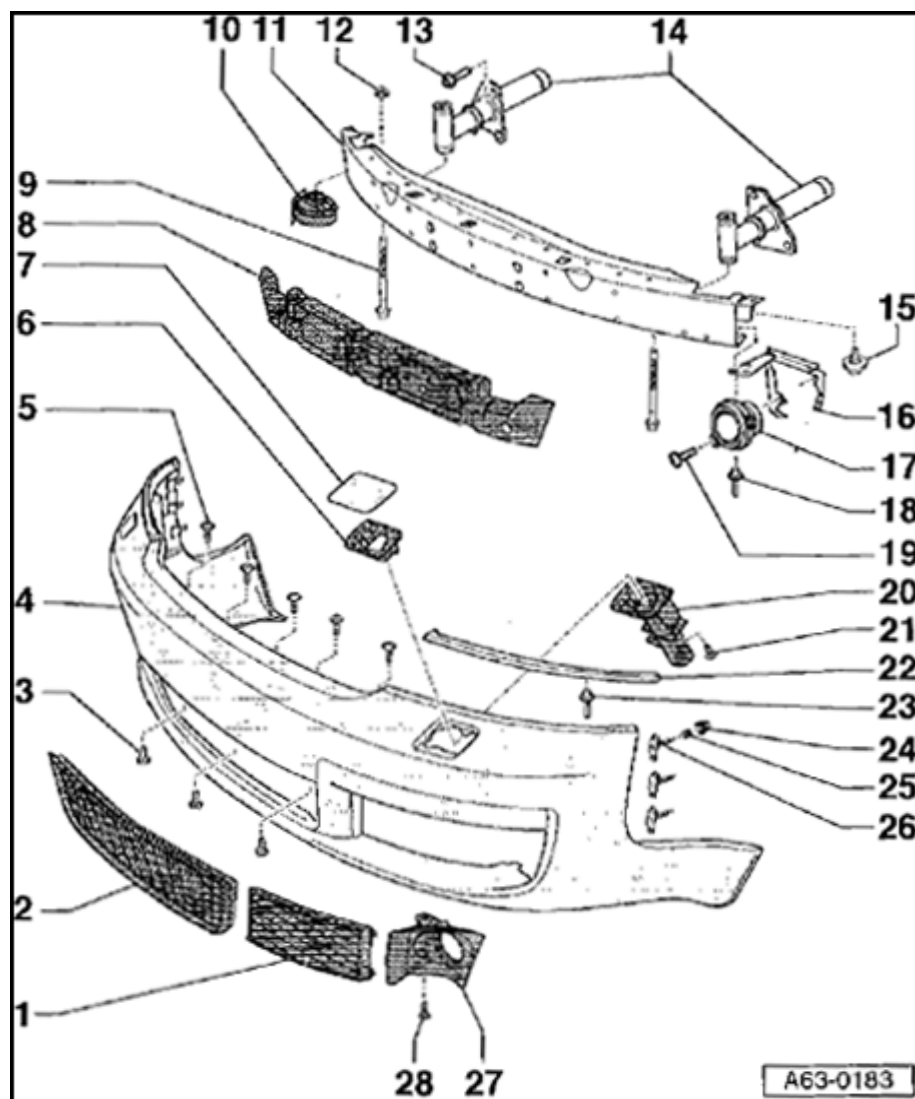

22 - Bumper trim piece

23 - Rivet

24 - Nut

◆ 4 Nm
(3 ft. lb)

◆ 6x

25 - Sleeve

◆ Prevents damage to paint surface of bumper cover and fender during removal and installation process

26 - Screw mount

◆ 6x

◆ Install sleeve - 25- before bumper cover installation

27 - Fog light cover

◆ for fog light

◆ Removal and installation
⇒ [Page 63-5](#)

28 - Screw

◆ 1.5 Nm
(13 in. lb)

◆ 4x

Fog light cover, removing and installing (Audi RS6 only)

Removing

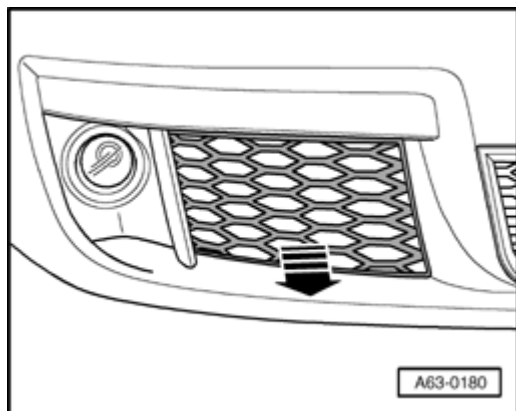

- ▶ - Pull air grille forward -arrow-

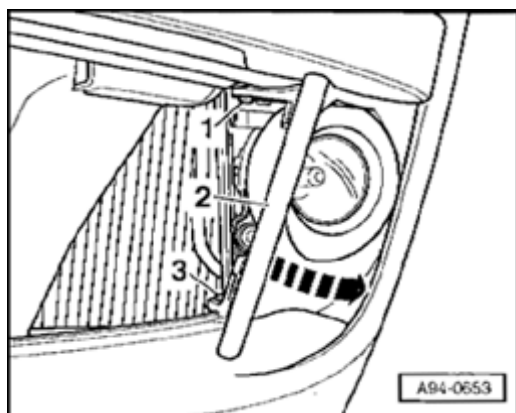

- ▶ - Remove screws -1- and -3-
- Swivel fog light cover -2- to outside edge of bumper cover -arrow-
- Remove cover

↔ **Front bumper** ↔ cover, removing
and installing (RS6 only)

Special tools, test equipment and auxiliary items

- ◆ 3094 Hose Clamps Up To 25MM Dia.

Removing

Note:

All wiring harness straps that have been cut or loosened during removal process must be replaced during installation process.

- Remove both front wheels

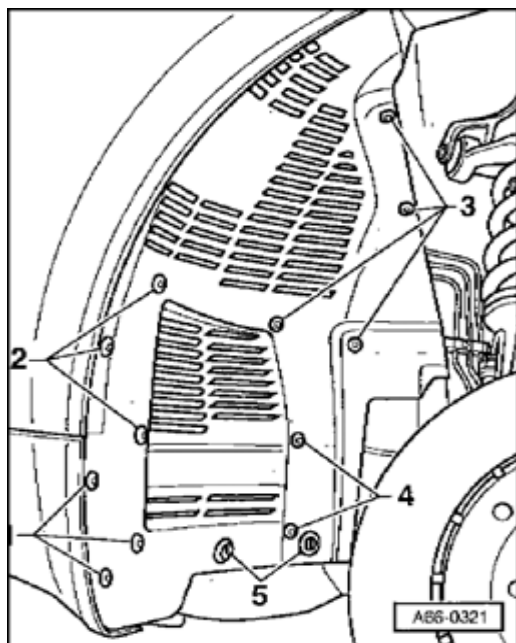

- Remove screws -1-, -2-, -3- and -4- and loosen quick-locking attachments for noise insulation panel
- Turn front half of wheel housing bowl toward rear.

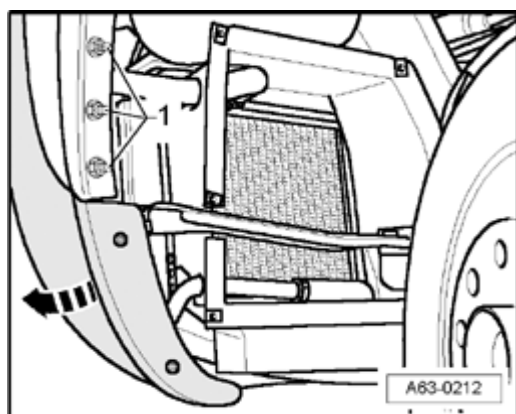

- Remove nuts -1- on both sides of vehicle
- To remove side cheeks of the bumper from guide carefully pull out in direction of -arrow-.

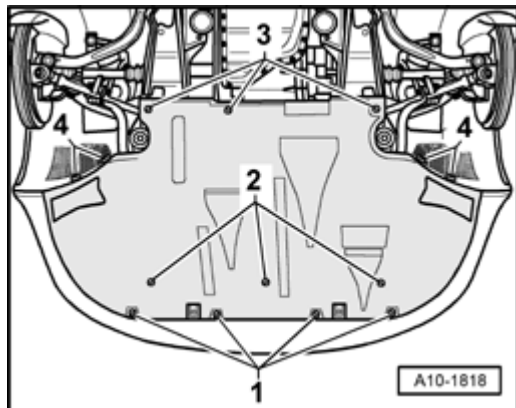

- ▲ - Remove screws -1-

Note:

Items -2- and -3- are not apart of this repair procedure.

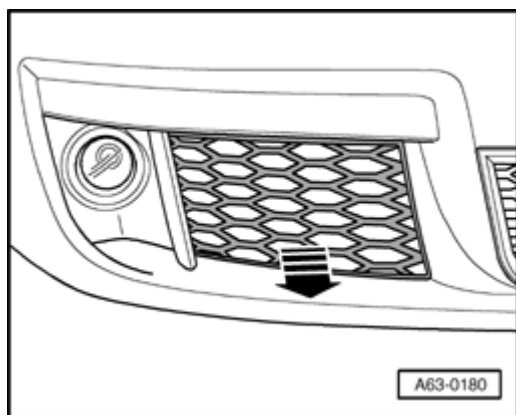

- ▲ - Pull cover forward from both sides starting from -arrow-

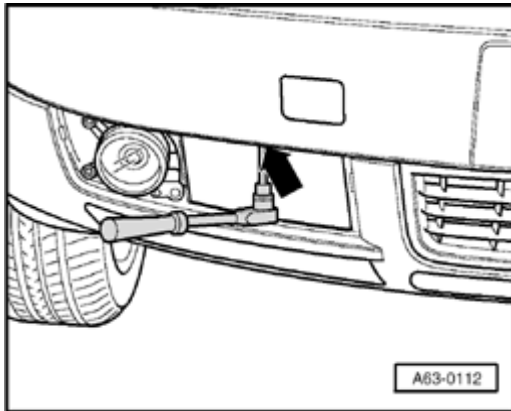

- Remove left and right retaining screws - arrow- for bumper
- Pull the bumper forward.
- Clamp headlight washer nozzle hose using tool 3094 Hose Clamp
- In addition, release water hose pressure by removing key
- Disconnect electrical connector
- Remove bumper assembly

Note:

Removal of bumper requires the assistance of a second technician

Installing

Installation is reverse of removal. In addition, the following is to be considered:

Note:

- ◆ *Replace all wiring harness straps in previous locations.*
- ◆ *Clips must be installed before bumper assembly is installed ⇒ [Page 63-12](#) .*
- ◆ *Impact absorber is installed vertical to the cross member and has height compensating elements ⇒ [Page 63-13](#) .*
- Make sure that the sleeve on screw mounting is attached to protect fender from scratching when installation of bumper is taking place
- Lock cover into guide

Tightening torque

Component		Nm (lb)
Bumper (at fender)		4 (3 ft lb)
Wheel housing liner	Guide	1.5 (13 in. lb)
	Body	1.5 (13 in. lb)
	Fender	1.5 (13 in. lb)
Bumper (at impact absorber)		23(17ft.lb)

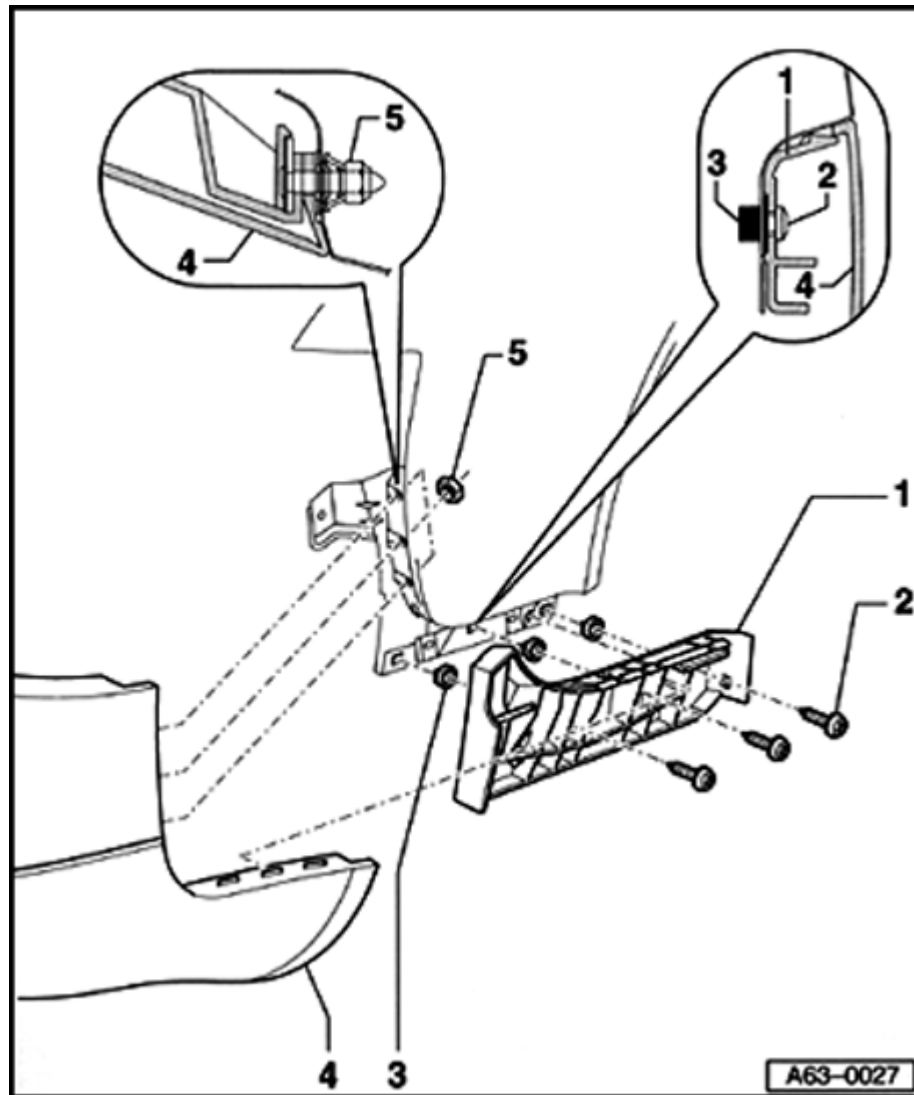

Guide, removing and installing (RS6 only)

1 - Guide

- ◆ Bumper removed
- ◆ To remove, unscrew self-tapping Phillips-head screw - 2-

2 - Self-tapping screw

- ◆ 1 Nm (9 in.lb)

3 - Clip

4 - Bumper cover

- ◆ Removing ⇒ [Page 63-6](#)

- ◆ When installing, bumper cover must latch cleanly into guide -1-

5 - Nut

- ◆ 6 Nm (4 ft.lb)
- ◆ Accessible only after loosening front half of wheelhousing liner ⇒ [Page 66-39](#)

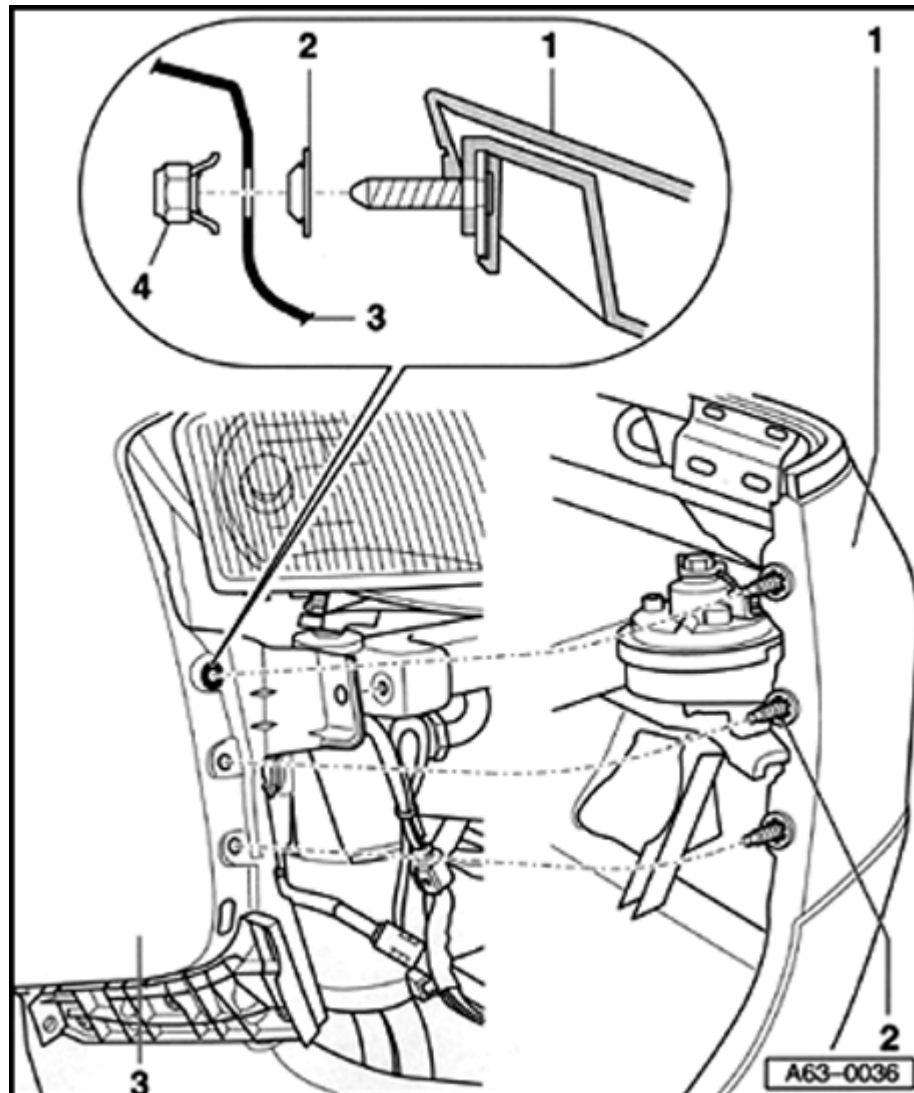

Bumper cover, attaching to fender (RS6 only)

1 - Bumper cover

- ◆ Slide on together with cross member and impact absorber.
- ◆ Clip into left and right guide on fender.
- ◆ Install flanged nuts -4- at fenders.

2 - Expanding clip

- ◆ Expanding clips must be pressed in before installing bumper cover -1- in fender

3 - Fender

4 - Flanged nut

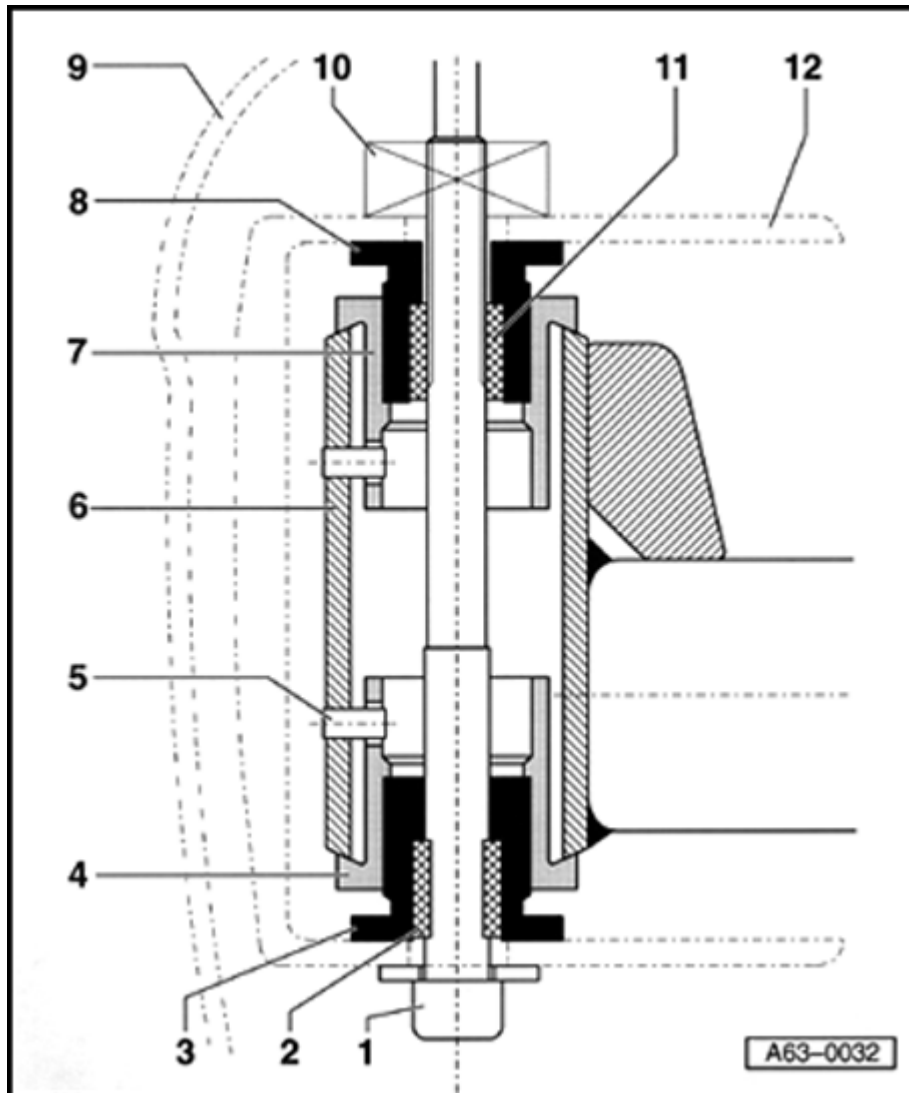

- ◆ 6 Nm (4 ft.lb)



Bumper, fastening to impact absorber (RS6 only)

Note:

◆ The bushings in the impact absorber compensate for tolerances in the height between the bumper and the impact absorber when the socket-head bolts are installed.

◆ The  front bumper  is held to the previously set position when socket-head bolts -1- are installed.

1 - Socket-head bolt

◆ 23 Nm
(16 ft.lb)

◆ M8 x 132

2 - Carrier bushing, lower

◆ Plastic part, pressed into adjusting screw

◆ No replacement

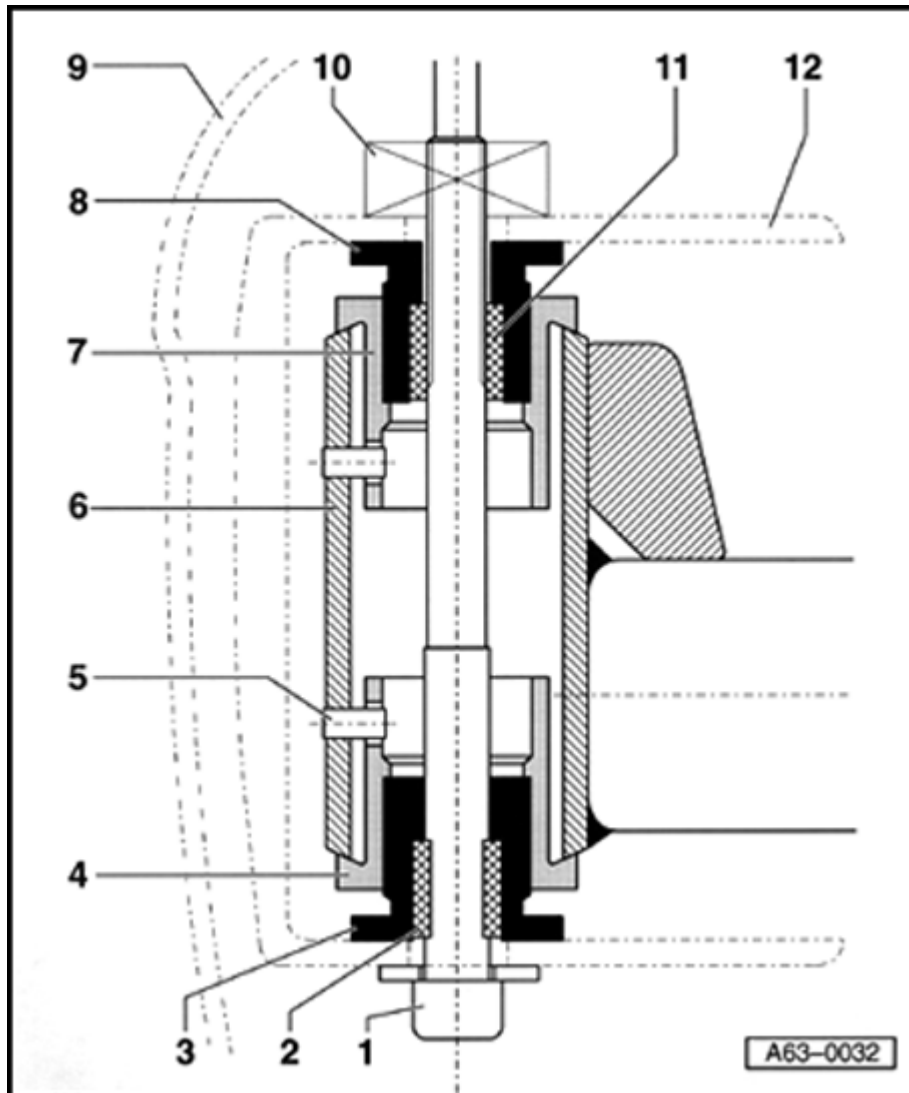

3 - Adjusting screw, lower

- ◆ Screw fully in before installing bumper
- ◆ Left-hand thread
- ◆ No replacement

4 - Threaded bushing, lower

- ◆ Secure with locking pin
- ◆ No replacement

5 - Locking pin

- ◆ No replacement

6 - Impact absorber

- ◆ Removing and installing ⇒ [Page 63-20](#).

7 - Threaded bushing upper

- ◆ Secure with locking pin
- ◆ No replacement

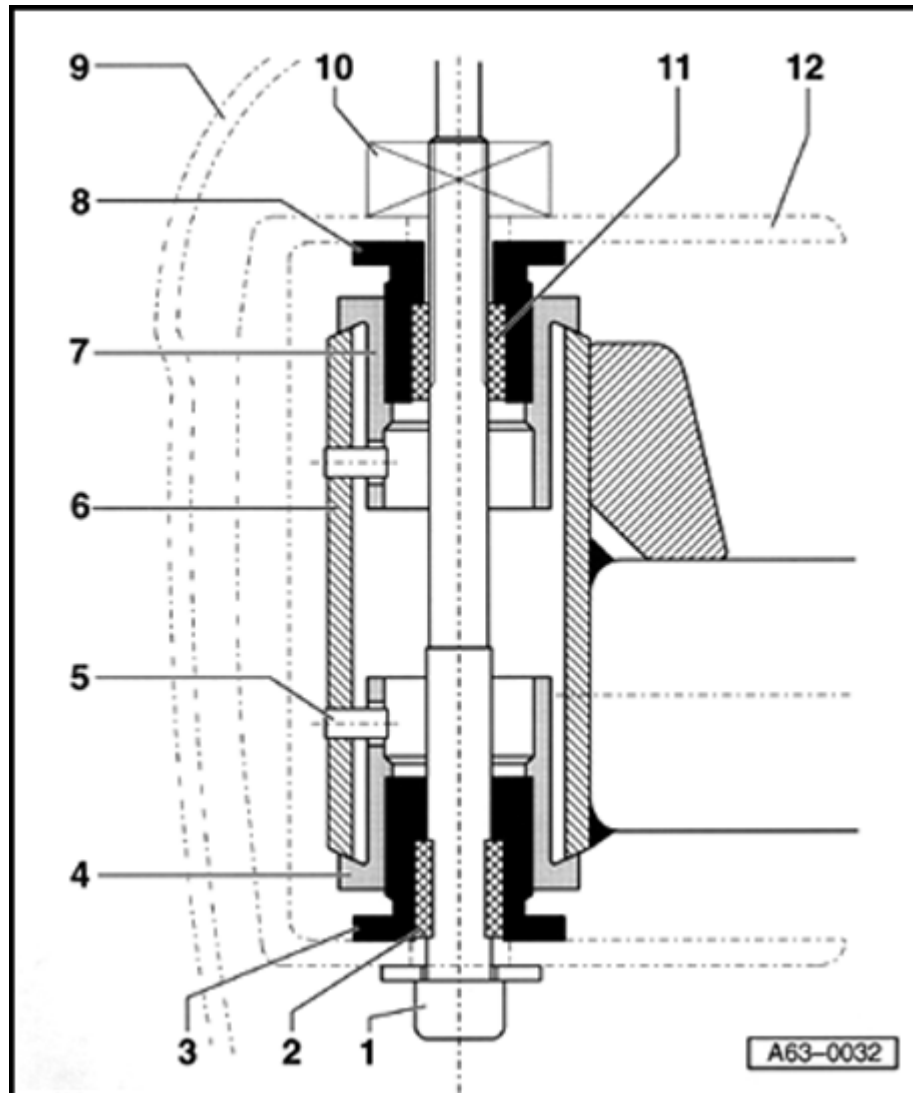

8 - Adjusting screw - upper

- ◆ Screw fully in before installing bumper
- ◆ Right-hand thread
- ◆ No replacement

9 - Bumper cover

- ◆ Removing and installing ⇒ [Page 63-6](#).

10 - Nut

- ◆ Supplied with replacement cross member

11 - Carrier bushing - upper

- ◆ Plastic part, pressed into adjusting screw

- ◆ No replacement

12 - Cross member

- ◆ Removing and installing ⇒ [Page 63-16](#)

Cross members for bumper cover, removing and installing (RS6 only)

Special tools, test equipment and auxiliary items

◆ VAS 5072 Pop Rivet Pliers

◆ Eye protection

◆ Drill

◆ Pop rivet

⇒ *Parts catalog*

Removing

- Remove bumper ⇒ [Page 63-6](#) .

- Remove fog light

⇒ *Repair Manual; Electrical Equipment; Lights, Switches - Exterior, Repair Group 94*

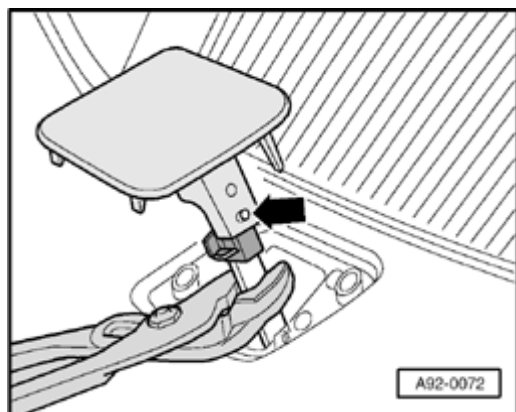

▲ - Carefully pull headlight washer cover upward to expose mounting plates - arrow-

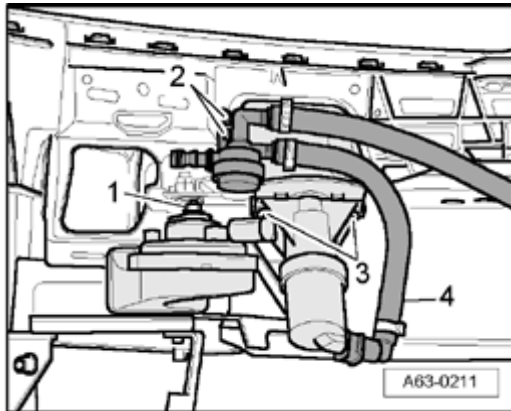

- ▲ - Remove water hose -4- on headlight washer nozzle (depress release key).
- Repeat procedure for opposite side of vehicle
- Remove nut -1- and screws -2-
- Remove horn assembly and headlight washer connector
- Remove screws -3- and remove spraying nozzle for headlight washer

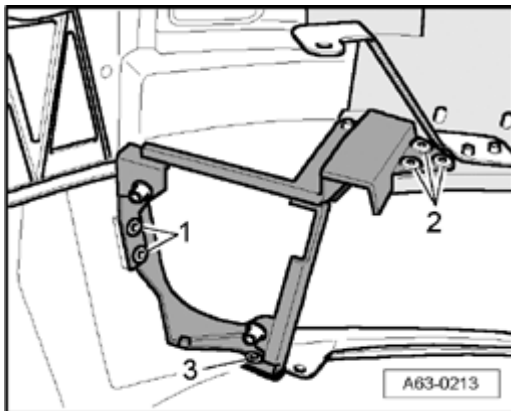

- ▲ - Drill out pop rivets -1-, -2- and -3- on bumper
- Remove for fog lights

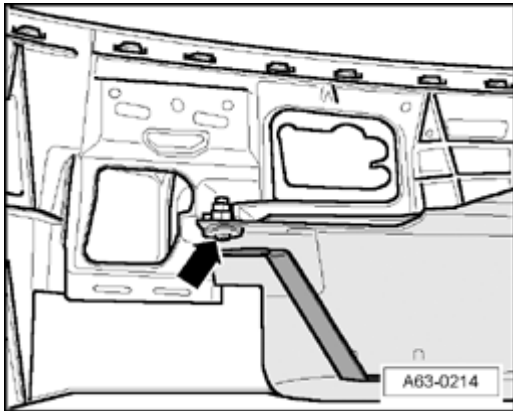

- Remove screw -arrow- at the left and right of cross member

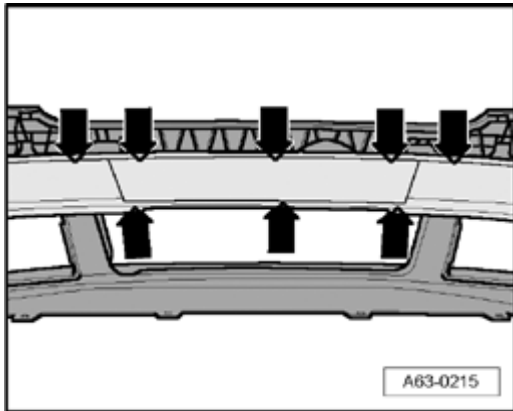

- Remove screws -arrow- for cross members
- Remove cross member and impact absorber from bumper

Installing

Installation is reverse of removal

Tightening torques

Component		Nm
Cross member	Inner	2.5 (22 in.lb)
	Outer	1 (9 in.lb)
Horn		11 (8 ft.lb)

Impact absorbers, removing and installing (RS6 only)

Removing

- Remove bumper ⇒ [Page 63-6](#) .

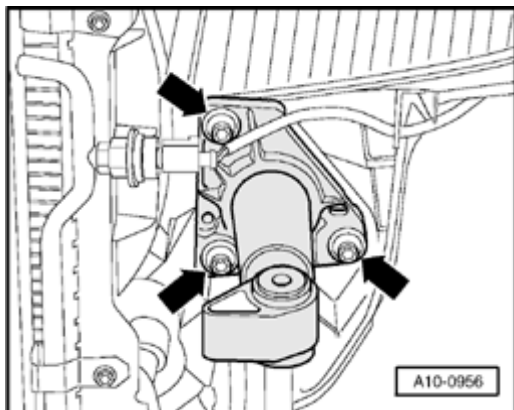

A

- Remove screws -arrow-
- Remove impact absorber from side member

Installing

Installation is reverse of removal

Tightening torques

Component	Nm
Impact absorber	50 (36 ft.lb)