

MODEL IDENTIFICATION



MODEL 211 (VAN)



MODEL 221 (MICRO-BUS)



MODEL 241 (MICRO-BUS)



MODEL 281 (PICK-UP)

MODELS	ALL MODELS LISTED ARE LHD	
211	VW Delivery Van	(Double door right)
213	VW Delivery Van	(Double door left)
215	VW Delivery Van	(Double doors left and right)
221	VW Micro Bus	(Double door right)
223	VW Micro Bus	(Double door left)
225	VW Micro Bus	(Double door right, sliding roof)
231	VW Kombi	(Double door right)
233	VW Kombi	(Double door left)
235	VW Kombi	(Double door right, sliding roof)
237	VW Kombi	(Double door left, sliding roof)
241	VW Micro Bus De Luxe	
251	VW Micro Bus De Luxe	(Seven-seater)
281	VW Pick-up	(Side panel lid right)
283	VW Pick-up	(Side panel lid left)
285	VW Pick-up	
285	VW Pick-up w/ Dbl. Cab	(Cab door - right)
287	VW Pick-up w/ Dbl. Cab	(Cab door - left)
281	VW Micro Bus	(Seven-seater, double door right)
285	VW Micro Bus	(Seven-seater, double door right, sliding roof)

The following list provides numbers of Chassis and Engine Parts for each year.

YEAR	CHASSIS	ENGINE	REAR AXLE	FRONT AXLE
JAN.	1954 20-060 409	20-695 356	2-070 257	A-169 153
	1954 20-110 604	20-945 529	3-111 671	A-380 323
MARCH	1955 20-117 902	20-991 590	3-120 231	A-418 355
	1955 21-160 116	20-117 147	2-153 204	A-322 609
	1955 222 217	1 478 216	3-220 700	A1044 020
	1955 222 209	2 158 321	3-117 211	A1039 148
APRIL	1955 274 824	2 171 114		B2215 331
	1955 274 756			B1124 646
	1955 274 309	3 400 000		B1124 646
MAY	1955 274 454			
	1955 274 454			
JUNE	1960 514 456	5 000 001		
	1960 705 819	5 407 725		B3523 946

LOCATION OF NUMBERS

Chassis No. TO:	20-117 901, on plate on partition in engine compartment.
Chassis No. FROM:	20-117 902, above plate on partition in engine compartment.
Engine No.:	On generator support below firing order.
Trans. & Rr. Axle:	On right hand transmission case behind shifting housing.
Front Axle No.:	On right hand suspension arm stop.

Prices are Factory Suggested List and subject to change w/o immediate notice.

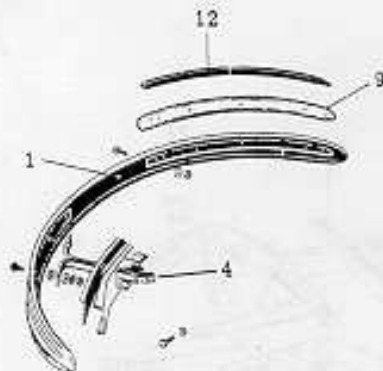

FRONT BUMPER - EARLY

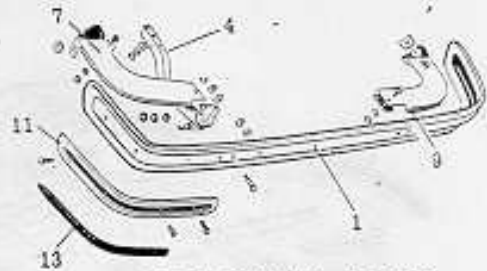

REAR BUMPER - EARLY

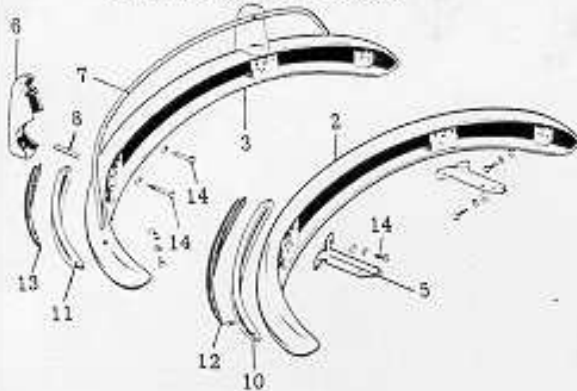

FRONT BUMPER - LATE

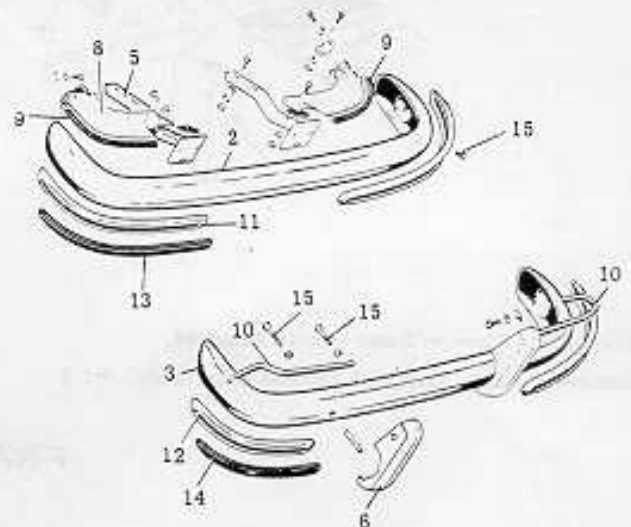

REAR BUMPER - LATE

Bracket Time w/ Bumper Removed.
Face Bar Time includes Mouldings.

* ARE FACTORY SUGGESTED ALLOWANCES
OTHER GLENN MITCHELL ESTIMATED

FRONT BUMPER

		TIME	PRICE
FACE BAR			
1	To 1958	#	.8 10.56
	From 1958-	#1	
2	Used w/o Guards		.8 19.15
3	w/ Guards		1.0 19.25
BRACKET			
4	To 1958	#	.2 1.45
5	From 1958-	#1	.2 1.75
6	GUARD		.2 6.85
7	RAIL		.8 11.75
8	Tube, Spacer		.15
MOULDING			
9	Approx. 34" long		.8 13.00
10	26" long		.8 7.45
11	Used w/ Guards		1.0 6.60
12	Rubber Profile, Moulding, exc.		2.40
13	Used w/ Guards		1.80
14	Bolts, each		.10
* To Ch. No. 384 999.			
#1 From Ch. No. 385 000-			

REAR BUMPER

		TIME	PRICE
FACE BAR			
1	To 1958	#	.8 14.95
	From 1958-	#1	
2	Used w/o Guards		1.0 21.20
3	w/ Guards		1.0 21.70
BRACKET			
4	To 1958	#	.2 5.95
5	From 1958-	#1	.2 6.30
6	GUARD		.2 6.95
GRAVEL SHIELD			
7	To 1958	#	1.1 3.40
8	From 1958-	#1	1.1 3.00
9	Rubber Seal, Shield		.30
10	RAIL		1.0 7.45
MOULDING			
11	Used w/o Guards		.8 7.60
12	w/ Guards		1.0 6.15
Rubber Profile, Moulding			
13	Used w/o Guards		2.30
14	w/ Guards		1.20
15	Bolts, each		.10
* To Ch. No. 384 999.			
#1 From Ch. No. 385 000-			

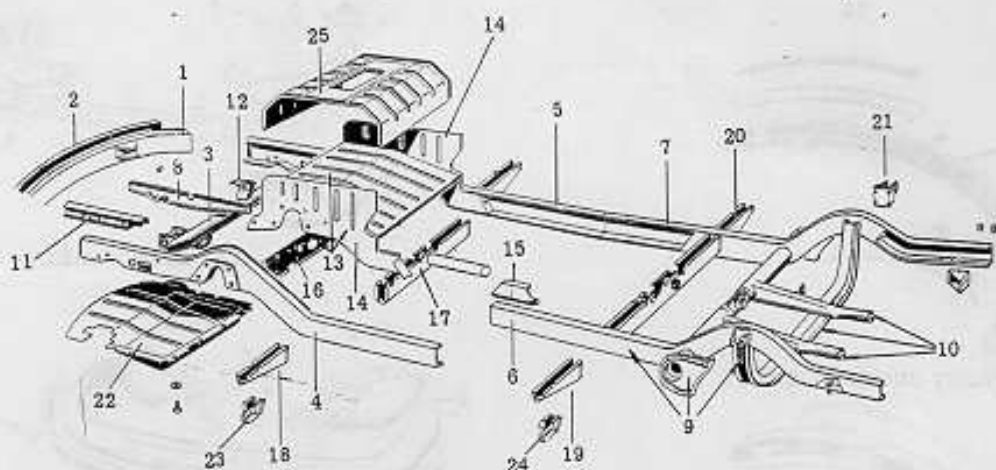

Inner Parts Time w/Outer Panels Removed.

Remove & Install Engine & Transmission Assy. * 1.6

FRAME

	TIME	PRICE		TIME	PRICE
CROSSMEMBER			GUSSETS		
1 Front Body, Inner	6.0	9.70	18 Front		1.65
2 (Face Plate, Outer		5.90	19 Center, Left		1.15
3 Front, Under Body		7.85	20 Right		1.45
SIDE RAIL			21 Bracket, Shock Mounting	1.0	.70
4 Front, Left	8.0	21.35	22 Plate, Linkage Cover	1.0	4.45
5 Right	8.0	19.15	Socket, Jack		
6 Rear, Left		14.55	23 Front	1.3	2.30
7 Right		15.30	24 Rear	1.3	2.85
8 Front Seat Support		1.15	25 BOX, Seat	3.5	6.15
9 REAR FRAME ASSY. *	30.0	114.25	UNDER FLOOR PLATE		
* Includes Both Side Rails & Engine Suspension Members. Time is w/Engine and Transmission Assy. Removed.			Left or Right		11.45
SUPPORT ASSY.			Center		15.30
10 Engine *	10.0	13.85	GUIDE TUBE		
11 Steering	1.0	4.85	Brake Cable		1.85
12 Hand Brake	1.0	1.85	Accelerator Cable		2.00
* w/Engine & Transmission Removed.			Choke Cable		1.10
REINFORCEMENT			Clutch Cable		1.40
13 Front Assy.					
To Mar. 1955		43.35			
From Mar. 1955-		30.85			
14 Front, One Side Only		5.35			
15 Side Member, Connection		.95			
16 Cross Plate, Front		1.90			
17 Intermediate Brace		2.35			

* ARE FACTORY SUGGESTED ALLOWANCES
OTHER GLENN MITCHELL SUGGESTED.

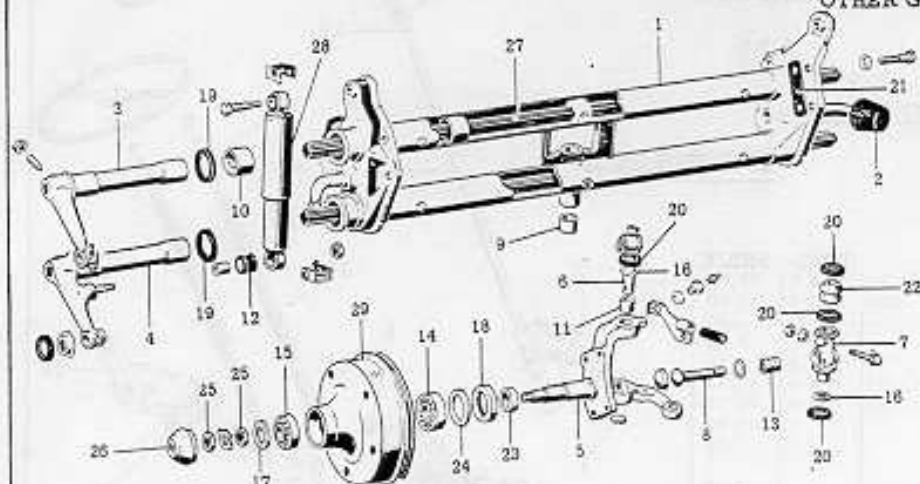

FRONT SUSPENSION

O/H FR.SUSPENSION

Time includes R&R Assy., & replace any or all parts as necessary; Check & Correct Alignment. Correct **DOES NOT** include Frame straightening.

* 13.1

CHECK ALIGNMENT

To align, replace bent parts or straighten Frame as necessary.

* 1.0

ADJUST TOE-IN

* .5

FR.SUSPENSION ASSY., R&R

* 3.8

AXLE ASSY.

1 BEAMS

To Mar. 1955
From Mar. 1955-

3 Stop Rubber

**3 CONTROL ARM, Upper
4 Lower**

*** R&R One or Both.**

5 KNUCKLE, Steering

To Mar. 1955
From Mar. 1955-

**6 King Pin, Upper
7 Lower**

8 Link Pin

BUSHING

9 Swing Shaft

10 Control Arm

11 King Pin

12 Shock Absorber

BEARINGS

13 Link Pin, Needle

14 Wheel, Inner

15 Outer

THRUST WASHERS

16 King Pin

17 Wheel Bearing

SEALS

18 Wheel Bearing

19 Control Arm

20 King Pin

SPACERS & SHIMS

21 Beams to Frame

22 Steering Knuckle

23 Front Wheel Bearing, Inner

24 Extractor Ring

25 Nut, Steering Knuckle

26 Grease Cap

TORSION SPRING

5 Leaves To Mar. 1955

4 Leaves To Mar. 1955

9 Leaves From Mar. 1955-

**28 SHOCK ABSORBER, Standard
Heavy Duty
Tropicalized**

29 DRUM, Front Brake

TIME PRICE
* 3.8 273.00

1	61.00
	54.90
.3	.45
	12.70
	14.45
* 1.3	
	32.50
* 2.9	34.55
	11.70
	13.45
	.60
	.75
	.55
	.95
	.30
	3.35
* .6	5.80
	5.05
	.15
	.10
	1.10
	.40
	.15
	.40
	.25
* 2.5	25.20
* 2.5	22.50
* 2.5	29.20
* .7	7.95
* .7	14.95
* .7	12.55
* .6	21.60

STEERING

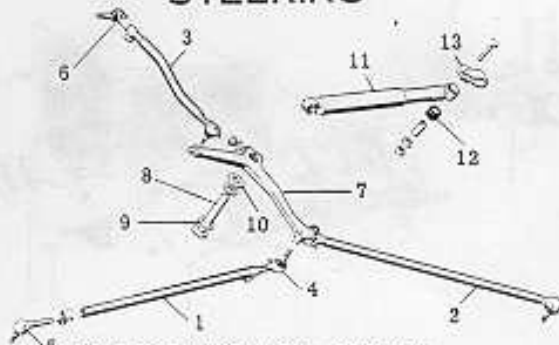

STEERING LINKAGE - TYPICAL

TIE ROD

1 Left, To Mar. 1955
From Mar. 1955-

2 Right, To Mar. 1955
From Mar. 1955-

3 DRAG LINK

To Mar. 1955

From Mar. 1955-

END, TIE ROD

4 Left Threads, To Mar. 1955

From Mar. 1955-

5 Right Threads, To Mar. 1955

From Mar. 1955-

6 END, DRAG LINK

To Mar. 1955

From Mar. 1955-

7 SWING LEVER

To Mar. 1955, Upper

Lower

From Mar. 1955-

8 Shaft, Swing Lever

To Mar. 1955, Upper & Lower

From Mar. 1955-

9 Thrust Washer

10 Seal

11 STEERING DAMPER

12 Grommet, Damper

13 Clamp w/ Bracket

TIME PRICE

	* .5	11.35
	* .5	9.95
	* .5	16.55
	* .5	8.35
	* .5	15.15
	* .5	10.80
	* .3	5.50
	* .3	4.15
	* .3	3.65
	* .3	4.15
	* .3	5.80
	* .3	4.30
	* .5	5.80
	* .5	4.45
	* .5	9.95
		.05
		.05
	* .4	10.55
		.30
		1.55

Continued

STEERING, Continued

- R&R STEERING GEAR ASSY. * 2.7
 † DOES NOT include Adjust Toe-In * .4
 O/H STRG. GEAR incl. R&R & ADJUST TOE-IN * 5.6

STEERING GEAR

	TIME	PRICE
1 STEERING GEAR ASSY.	* 2.7	79.95
2 Case	O/H * 5.6	19.00
3 Cover, Case		4.60
4 End w/Tube		3.40
5 Bracket, Steering	* 2.8	5.55
6 TUBE & WORM	O/H * 5.6	35.10
7 SECTOR w/ BEARING & PEG	O/H * 5.6	31.85
8 Taper Bearing		10.80
9 Seal, Sector BEARING		1.00
10 Race, Shaft, Upper		2.30
11 Lower		2.30
12 Ball, 1/4" (28 Required)		.05
13 Sleeve, Upper Bearing		1.35
14 TUBE, Column		5.00
15 ARM, PITMAN		5.10
16 Horn Button LOCK, Steering & Ignition		11.70

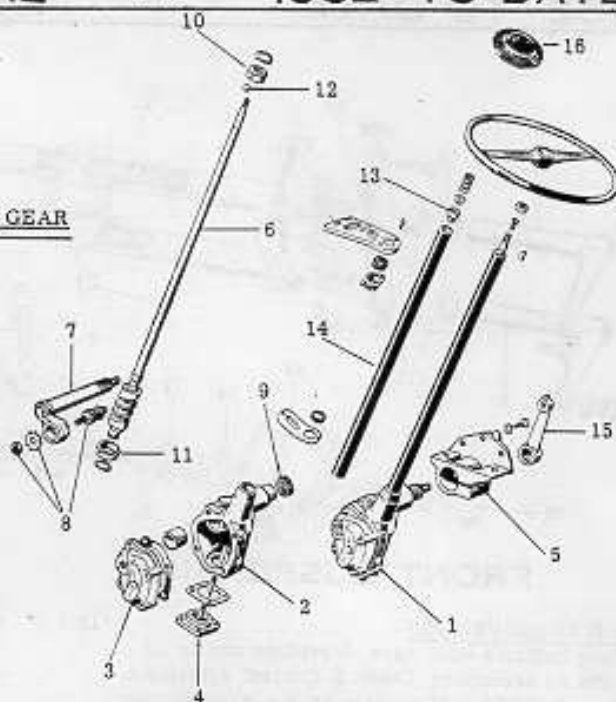

TRANSMISSION & SUPPORTS

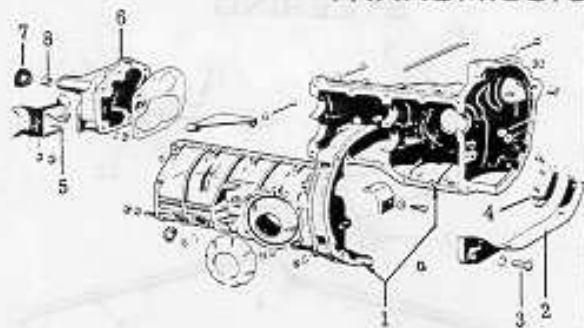

Transmission Assy., R&R * 6.0
 Time includes R&R Engine.

O/H Assembly, Completely *16.9
 Time includes R&R Engine & Trans.
 Assy., ALSO includes Replace Clutch
 Parts as necessary.

TO MAY 1959

1 CASE	* 14.6	69.00
* Time includes R&R Assy. & Partially D&A, as well as, Replace any parts listed below that are needed.		
2 Bracket w/Strap		2.35
3 Bolt, Trans. Mtg.		.60
RUBBER CUSHION		
4 Rear		1.55
5 Front		1.10
6 Housing, Gear Shift	* 1.0	7.00
* Time w/Assy. Removed.		
7 Gasket, to Frame		.30
8 Bushing, Housing, Std. Size	* 1.2	.25
9 Oversize	* 1.2	2.55
* Time w/Assy. Removed.		
Shim, between Case & Tube		.20

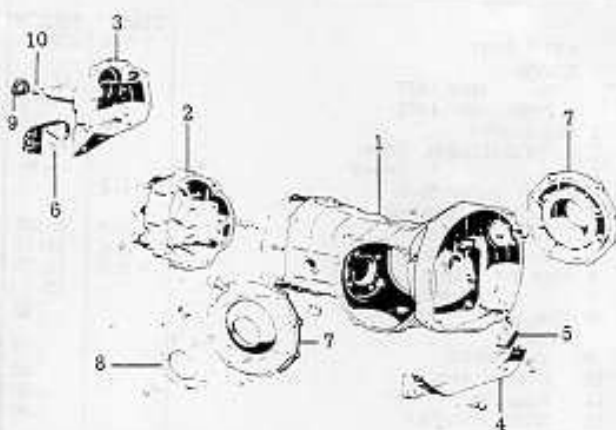

Transmission Assy., R&R * 5.1
 Time includes R&R Engine Assy.

FROM MAY 1959-

1 CASE	* 12.5	57.95
* Time includes R&R Assy. & Partially D&A, as well as, Replace any parts listed below that are needed.		
2 Gear Carrier		7.35
3 Housing, Gear Shift	* .6	
* Time w/Assy. Removed.		
4 Strap		2.35
5 RUBBER CUSHION, Rear		1.55
6 Front		2.30
7 Cover	* 6.40	
* R&R One Side 8.6, Both 10.2 Time includes Adjust Ring Gear, Both sides incl. R&R Diff. Brgs., if necessary.		
8 Shim		.20
9 Gasket, to Frame		.35
10 Bushing, Shift Hsg., Std. Size	* .6	.25
Oversize	* .8	2.65

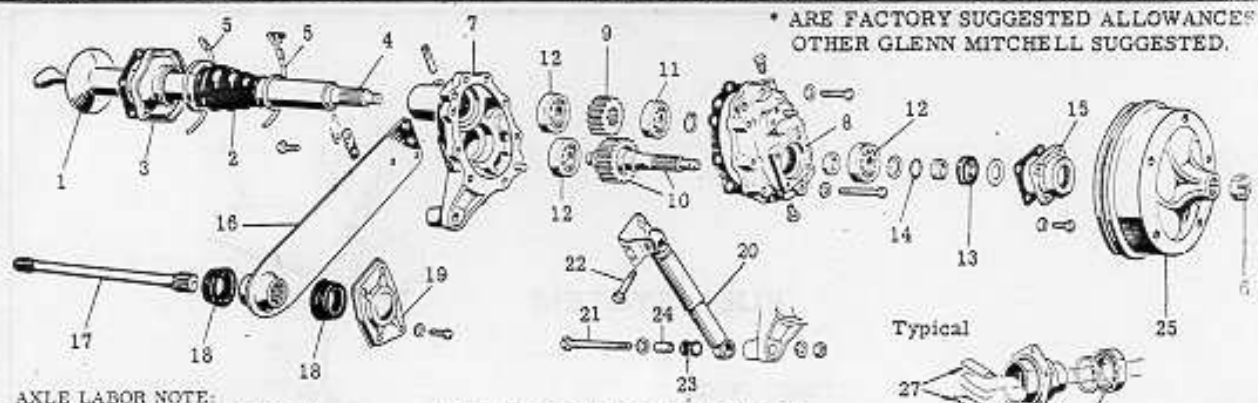

AXLE LABOR NOTE:

R&R Axle Shaft, incl. R&R Assy.
w/Two Pc. Trans. (One or Both) *12.0
w/One Pc. Trans., One * 6.5, Both * 7.4
Time incl. Adjust and/or Replace Diff. Brg.

REAR SUSPENSION

	TIME	PRICE		TIME	PRICE
1 TUBE, Rear Axle	* 4.1	6.25	13 SEALS, Wheel, Outer		.95
2 Boot, Split Type	* 1.0	1.75	14 Inner		.20
3 Retainer, Tube		2.00	15 Cover, Bearing		2.30
4 SHAFT, Rear Axle - SEE Labor Note above.			16 SPRING PLATE		
4A Fulcrum Plate, Axle (Std. or O.S.)		1.05	To Mar. 1955		9.35
5 Clamp, Boot		.10	From Mar. 1955-		9.90
6 Nut, Rear Axle HOUSING		1.66	17 TORSION BAR		19.50
7 Reduction Gear			18 Rubber Bushing, Plate		.45
To Mar. 1955	* 3.6	19.50	19 Cover, Plate, Hub		1.70
From Mar. 1955-	* 3.6	13.05	20 SHOCK ABSORBER, Telescopic Std.	* .8	7.90
8 COVER, Housing			Heavy Duty	* .8	14.40
To Mar. 1955		10.90	Tropicalized	* .8	10.20
From Mar. 1955-		15.85	Lever Type, Not Illust.	* .8	8.90
9 GEAR, Axle, exc.		7.50	21 Bolt, Lower Shock		.30
Use in Mountains.		8.15	22 Upper Shock		.15
10 Driven, exc.		19.05	23 Rubber Grommet		.20
Use in Mountains.		20.75	24 Bushing, Grommet		.15
BEARING			Link, Lever Shock (Not Illustrated.)		.10
11 Axle		3.25	Bushing (Not Illustrated.)		.40
12 Wheel		4.80	25 DRUM, Rear Brake		25.30
12A Differential, To May 1950	* 10.2	5.65	26 Bearing, Differential		6.10
From May 1950-	* 10.2	10.10	27 Fulcrum Plate, Rear Axle, Std. or O.S.		1.05
* Incl. R&R Assy., Replace Axles if nec., and Adjust Ring Gear.					

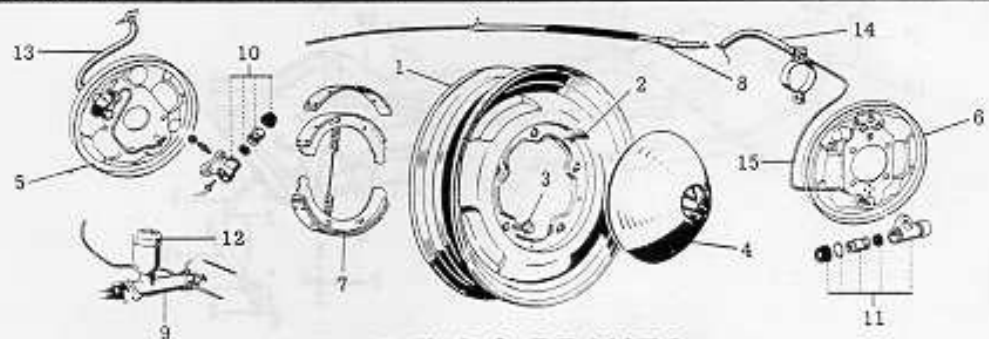

WHEELS & BRAKES

1 WHEEL, To Mar. 1955	.3	15.60	9 CYLINDER		
From Mar. 1955-	.3	15.60	Master	* 1.5	16.75
2 Spring, Hub Cap Ret.	* .2	.02	10 Front Wheel, To Mar. 1955	* 1.3	7.85
3 Bolt, Wheel		.25	From Mar. 1955-	* 1.3	8.05
4 Hub Cap, Chrome Painted		3.45	11 Rear Wheel, To Mar. 1955	* 1.3	7.35
Trim Ring		1.85	From Mar. 1955-	* 1.3	7.85
BACKING PLATE		4.55	* Includes R&R Drum.		.6
5 Front, To Mar. 1955	* 1.2	5.15	REPAIR KIT		
From Mar. 1955-	* 1.2	2.00	Master Cylinder, (incl. R&R)	* 2.7	2.00
6 Rear, To Mar. 1955	* 1.1	3.40	Wheel Cylinder, (incl. R&R .6)	* 1.8	1.00
From Mar. 1955-	* 1.1	4.30	12 Reservoir, Master Cylinder	.5	1.05
7 SHOE w/ LINING		3.45	13 HOSE, Front Brake	* .9	4.90
8 CABLE, Rear Brake		5.75	14 Rear Brake	* .9	4.15
			* Includes Bleed Brakes.	* .7	
			15 Pipe, Rear Brake	1.0	.75

FUEL SYSTEM

- TANK
- 1 To Mar. 1955
2 From Mar. 1955-
- 3 Cap. Approx. 4" Dia.
3" Dia.
2 3/8" Dia.
- 4 Grommet, Tank Neck
5 Strap
- VALVE ASSY., Shut-Off
- 7 To Mar. 1955
8 From Mar. 1955-
- 9 Filter Bowl
10 Filter, in Tank
11 Gasket, Tank
12 Cap, Large
13 Small
- FUEL PUMP
CARBURETOR
REPAIR KIT
Fuel Pump
- GAUGE, Tank Unit
To Mar. 1955
From Mar. 1955-

TIME PRICE

	TIME	PRICE
1	* .9	24.30
2	* .9	24.30
3		2.00
		1.50
		.95
		.75
		.26
7		4.25
8		2.60
9		.30
10		.45
11		.50
12		1.35
13		.75
FUEL PUMP	* .5	9.95
CARBURETOR	* .6	24.95
REPAIR KIT		
Fuel Pump	* 1.5	1.95
GAUGE, Tank Unit		
To Mar. 1955		8.10
From Mar. 1955-		13.45

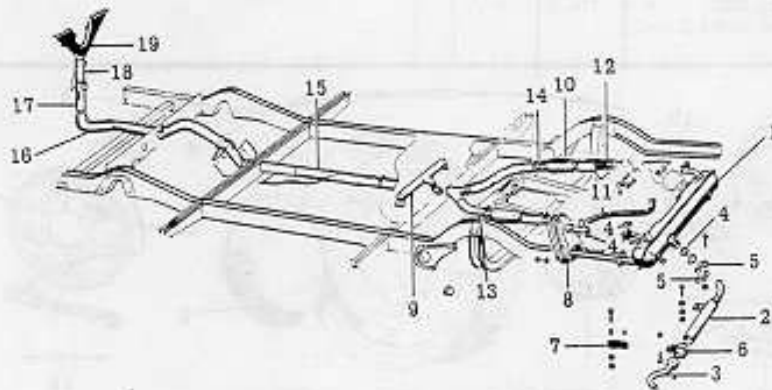
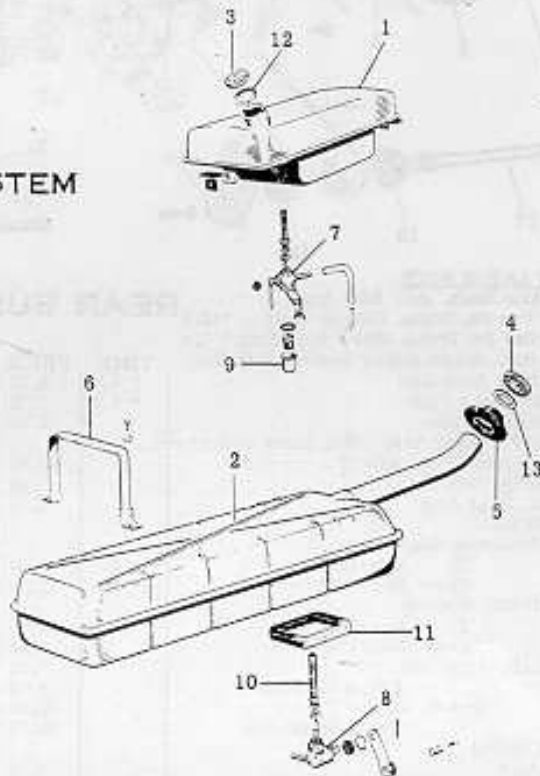

EXHAUST & HEATER

	TIME	PRICE		TIME	PRICE
1 MUFFLER, Exhaust			8 HEATER JUNCTION BOX	1.3	9.95
To May 1953	* 1.1	13.50	9 Heater, Rear		7.50
From May 1955-	* 1.1	17.80	10 Muffler, Heater		2.20
2 Muffler Pipe			11 Pipe, Flex. Pre-Heat		.85
Used May 1959 to Ch. 5 822 012	.2	4.60	12 Heater		1.00
From Ch. 5 822 013-	.2	4.90	13 Heater, End Piece, Right		2.25
Tail Pipe, Muffler, Van & Pick-Up	.2	.95	14 Heater, End Piece, Left		3.05
Micro Bus	.2	3.10	15 Intermediate		1.65
3 Exhaust	.2	1.70	16 Front		3.50
4 Seal, Muffler		.15	17 Distributor		4.30
5 Clip, Exhaust Pipe		.15	18 Junction Piece		1.55
6 Tail Pipe		.30	19 End Piece, Front		4.30
7 Rubber Buffer		.25			

* ARE FACTORY SUGGESTED ALLOWANCES
OTHER GLENN MITCHELL SUGGESTED.

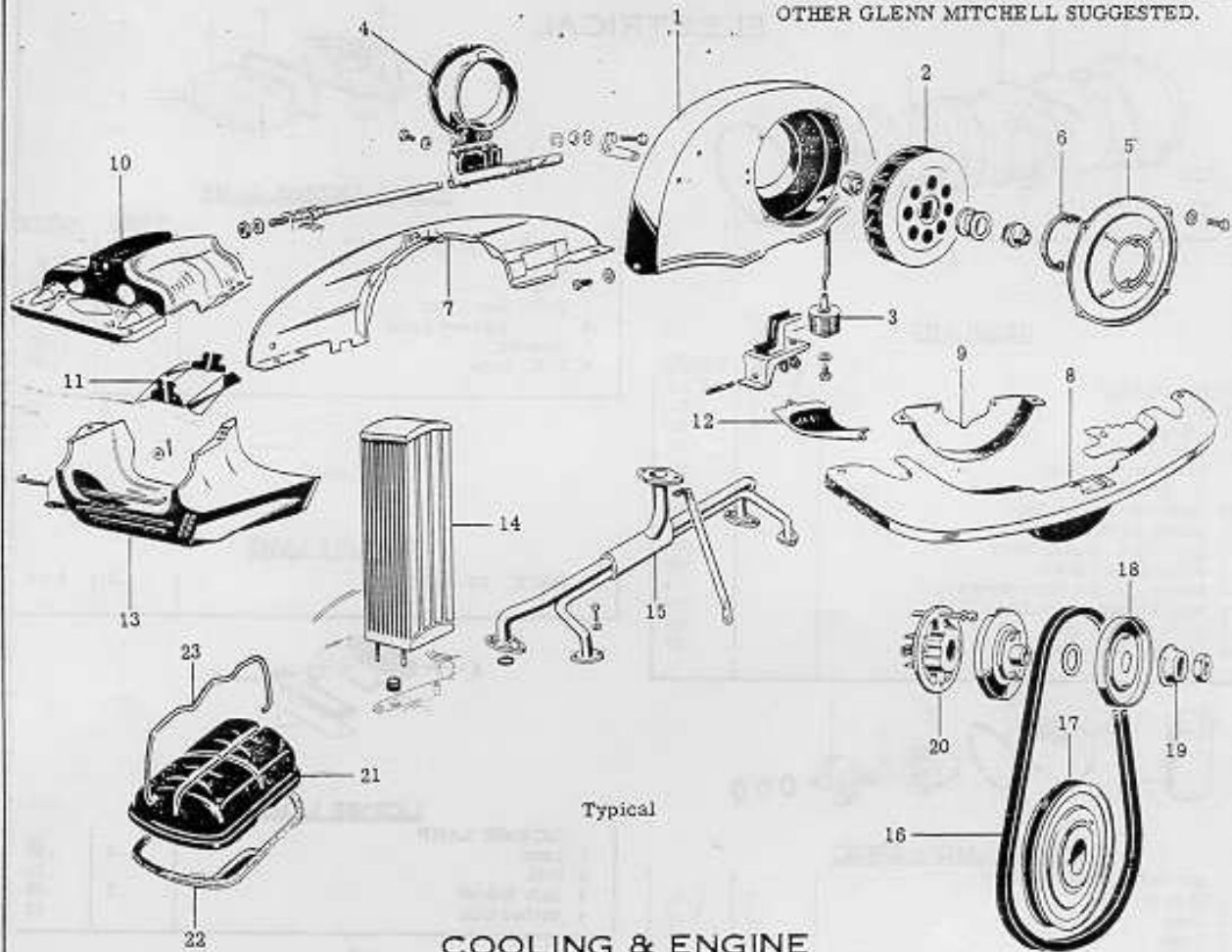

COOLING & ENGINE

	TIME	PRICE		TIME	PRICE
AIR COOLING					
1 HOUSING, Fan	*	3.55	15 INTAKE MANIFOLD		
2 FAN	*	4.55	Standard	* 1.6	10.55
* O/H w/ Engine in Car.	* 2.1		Use w/Governor	* 1.6	9.30
w/ Engine Removed.	* .6		16 BELT, Generator	* .5	
3 Thermostat		4.55	Approx. 1/2" Width	* .3	.95
4 Throttle Ring		1.90	3/8" Width	* .3	1.70
5 Cover, Fan		1.05	17 PULLEY, Crankshaft	* .5	4.70
6 Reinforcement, Flange Cover		.25	18 Generator	* .3	1.70
COVER PLATE			19 Hub, Pulley		.60
7 Engine, Front, To May 1959		2.00	20 Plate, Generator End		
From May 1959-		2.30	130 Watts, Gen.		5.30
8 Rear, To May 1959	.7	3.55	160-180 Watts, Gen.		3.75
From May 1959-	.7	2.50	21 VALVE COVER		
9 Below Crank Pulley	.7	.85	w/ Breather		1.85
10 Side	2.0	2.60	w/o Breather		.35
11 Air Deflector		.25	22 Gasket, Cover		.15
12 Fuel Pump		.30	23 Ret. Spring		.30
13 HEATER CHANNEL			DISTRIBUTER		
Left	* .9	5.25	To June 1960	* .5	16.75
Right	* .9	4.85	From June 1960-	* .5	20.95
14 OIL COOLER	*	13.45	Cap, Distributer	* .3	2.10
* Time w/ Engine in Car.	* 2.1		Points, Set	* .5	1.45
w/ Engine Removed.	* .8				

ELECTRICAL

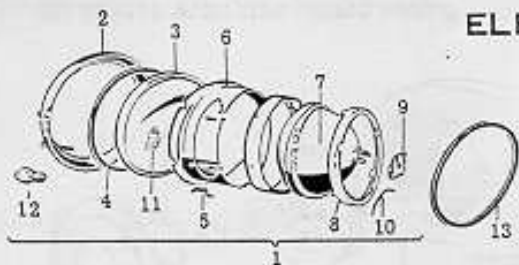
HEADLAMP

	TIME	PRICE
1 HEADLAMP	* .4	17.15
2 Rim	* .6	5.25
3 Glass	* .6	1.80
4 Seal, Glass		.40
5 Ret. Spring, Glass		.05
* 7 Required.		
6 Retainer, Sealed Beam		2.00
7 Sealed Beam, USA Mfg.	.3	2.50
8 Lock Ring, Sealed Beam		1.30
9 Plug, Sealed Beam		.50
10 Spring, Sealed Beam Retainer		.20
11 Bulb Holder, Park Light		.75
12 Bulb, Park Light		.20
13 Gasket, to Fender		.30

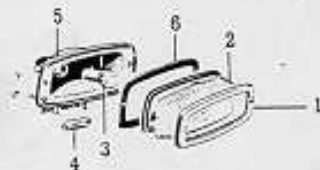
STOP & LICENSE LAMP

	TIME	PRICE
STOP & LICENSE LAMP		
1 Rim	.2	1.40
2 Lens		1.45
3 Bulb, Stop Lamp		
4 License Lamp	* .5	1.85
5 Housing		.20
6 Seal, Lens		

BACK-UP LAMP

1 BACK - UP LAMP	.3	6.85
------------------	----	------

SIGNAL LAMP - FRONT

SIGNAL LAMP - FRONT		
1 Bulb Holder	.3	1.35
2 Lens	.2	2.35
3 Case	.2	1.00
4 Gasket		.50
5 Bulb		.35
6 Flasher Unit Relay	.2	4.05

LICENSE LAMP

LICENSE LAMP		
1 Lens	.2	.55
2 Seal		.15
3 Bulb Holder	.3	.65
4 Rubber Cap		.20

HORN

1 HORN, Bosch	* .4	7.75
Hella	* .4	8.25

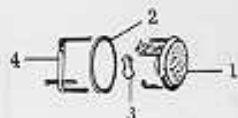
TAIL LAMP - TO 1958, CH.351 735

1 TAIL LAMP ASSY.	.3	2.70
2 Gasket		.05
3 Bulb		
4 Bracket		.15

SIGNAL LAMP - REAR

SIGNAL LAMP - REAR		
1 Rim	.2	2.35
2 Lens		1.70
3 Seal		.60
4 Body	.3	2.00
5 Bulb		

TAIL & STOP LIGHT - FROM 1958- CH.351 736-

TAIL & STOP LIGHT		
1 Rim		2.35
2 Lens	.2	1.70
3 Seal		.40
4 Bulb		
5 Body	.3	2.80

REFLECTOR - REAR

1 REFLECTOR - REAR	.2	.70
--------------------	----	-----

(CONTINUED)

ELECTRICAL (CONTINUED)

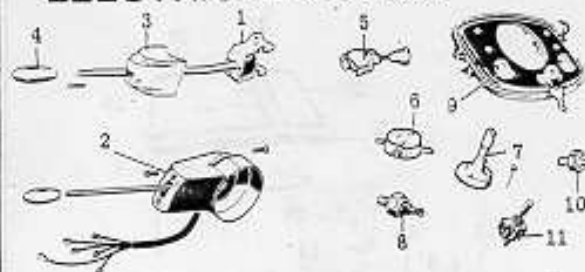

SWITCHES

Compare w/Illustration For Usage.

	TIME	PRICE
SWITCH ASSY., Signal Light		
1 Early Type	.5	4.10
2 Late Type w/Housing		9.70
3 Case, Early Switch		.50
4 Knob		.20
5 Headlamp	.5	2.70
6 Reverse	.5	1.95
7 Dimmer, for Headlights	.6	1.90
8 Oil Pressure (at Engine)	.3	1.70
9 Light & Windshield Wiper, To Mar. 1955	.5	.30
10 Stop Light	.5	1.20
11 Tumbler Switch	.3	.60



FUSE BOX

1 FUSE BOX		
6 Fuses	.3	2.30
8 Fuses	.4	2.50
Fuse		



INSTRUMENT PANEL

	TIME	PRICE
INSTRUMENT PANEL		
1 Bakelite Plate		
To Mar. 1955	* 1.1	13.45
From Mar. 1955-	* 1.1	10.55
2 Fuel Gauge, Instrument Panel	.5	8.10
3 Clock, Electric	.5	22.70



WINDSHIELD WIPERS

	TIME	PRICE
WINDSHIELD WIPERS		
BRACKET w/ARM		1.55
* Aluminum Color		
1 Bracket Only		1.55
Aluminum Color		1.15
Chrome		1.60
2 Arm w/Blade		
Aluminum Color		1.85
Chrome		2.60
Blade Only		.45
3 MOTOR		
To Mar. 1955	* 1.1	11.39
From Mar. 1955-	* 1.1	16.59
4 SHAFT w/CRANK	.5	1.15
5 Coupling Rod Assy.	.5	1.85
6 Switch	.3	1.15
7 Knob		.20

* ARE FACTORY SUGGESTED ALLOWANCES
OTHER GLENN MITCHELL SUGGESTED.

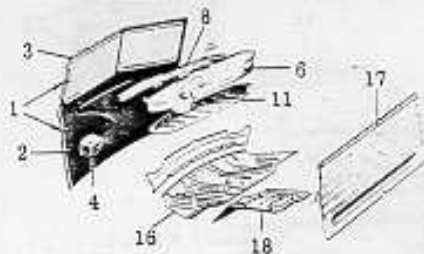

FR.OUTSIDE, ALL YEARS & MODELS AND
FR.INSIDE PARTS SHOWN AFTER MAR.1955.

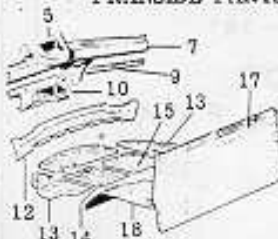

FR.INSIDE PARTS
SHOWN TO MAR.1955.

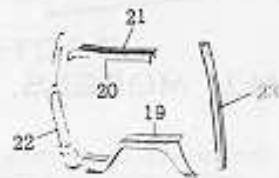

FR.DR.SILLS & PILLARS,
ALL YEARS & MODELS.

GLASS - SEE PAGE C13, MOULDINGS - SEE PAGE C14.

FRONT BODY - ALL MODELS

	TIME	PRICE
1 FRONT PANEL, COMPLETE	*23.0	46.80
2 Lower Part	*15.5	29.30
3 Upper Part	*13.0	17.10
4 Housing, Headlamp	1.5	2.10
INSTRUMENT PANEL		
5 To Mar. 1955, exc. Model 241	3.5	4.50
6 From Mar. 1955-	10.0	29.55
7 Cover Plate, Inst. Panel, To Mar. 1955	10.0	27.00
8 Reinforcement, To Mar. 1955	8.0	21.90
9 From Mar. 1955-		4.15
10 Support, Inst. Panel, To Mar. 1955		1.50
11 Shelf, Front, From Mar. 1955-		7.30
12 Reinforcement, Front, i.s. Lower	3.0	7.60
	3.0	5.35
FRONT FLOOR TO MAR. 1955		
13 Floor, Side	3.0	6.00
14 Center, Left	2.5	3.10
15 Right	2.5	5.00
FRONT FLOOR FROM MAR. 1955-		
16 Floor, Complete		
Mar. 1955-1959, Ch. 501 706	5.0	12.65
From 1959-, Ch. 501 707-	5.0	16.40
17 Partition	6.0	24.75
18 WHEELHOUSE, Front	4.5	10.35
19 ANGLE PLATE, Below Cab Door	* 6.4	20.95
20 Sill, Above Cab Door	2.5	5.40
21 Cover Plate, Sill		1.65
PILLARS		
22 Cab Door, Hinge		15.65
23 Lock	*1	9.75
* R&R w/o Outer Panels Removed, w/Outer Panels Removed.	* 9.2	6.0
*1 R&R w/o Outer Panels Removed, w/Outer Panels Removed.	* 9.8	6.0

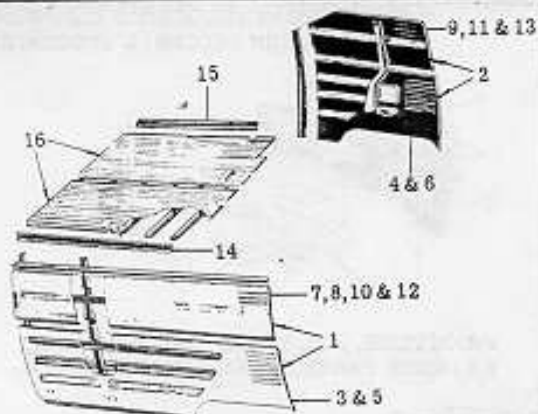

BODY-SIDE ALL MODELS, EXC. PICK-UP

	TIME	PRICE
SIDE PANEL ASSY., FROM MAR. 1955-*		
1 On Side, w/o Loading Doors		
Delivery Van	32.0	139.00
Micro Bus & Kombi, exc.	*34.0	151.40
Delux Micro Bus	*34.0	164.70
2 w/ Loading Doors		
Delivery Van	29.0	126.20
Micro Bus & Kombi, exc.	31.0	132.55
Delux Micro Bus	31.0	156.65

* Part includes Pillars & Reinforcements.
Time includes Remove & Install Doors,
Windows, Wiring & Trim Panels, as nec.
DOES NOT include Transfer Parts on Doors.

	TIME	PRICE
SIDE LOWER SECTION		
3 Left Side, w/o Loading Doors		
To Mar. 1955		43.40
From Mar. 1955-	#1	47.40
4 w/ Loading Doors		
To Mar. 1955		24.65
From Mar. 1955-	#1	26.35
5 Right Side, w/o Loading Doors		
To Mar. 1955		41.10
From Mar. 1955	#1	52.30
6 w/ Loading Doors		
To Mar. 1955		21.90
From Mar. 1955-	#1	27.50
* Part includes Reinforcements on Models after 1955.		
#1 Time for Models after 1955:		
Delivery Van	21.0	
Micro Bus & Kombi	*23.0	

	TIME	PRICE
SIDE UPPER SECTION		
7 Delivery Van		
Model 211, Side w/o Doors	20.5	32.10
Model 213, Side w/Doors	20.5	29.35
Side w/ Loading Doors	18.5	19.55
8 Micro Bus		
Left Side, w/o Loading Doors	21.5	30.05
w/ Loading Doors	20.0	33.90
Right Side, w/o Loading Doors	21.5	35.70
w/ Loading Doors	20.5	18.40
9 Kombi		
Left Side, w/o Loading Doors	*22.5	30.05
w/ Loading Doors	20.5	33.90
Right Side, w/o Loading Drs., exc.	*22.5	35.70
Model 241 (Dlx.)	*22.5	41.00
w/ Loading Doors	20.0	18.40
14 SILL, Floor Side, exc.	3.5	3.25
15 Loading Door, Sill	3.0	3.20
16 FLOOR, Loading Compartment	20.0	18.45

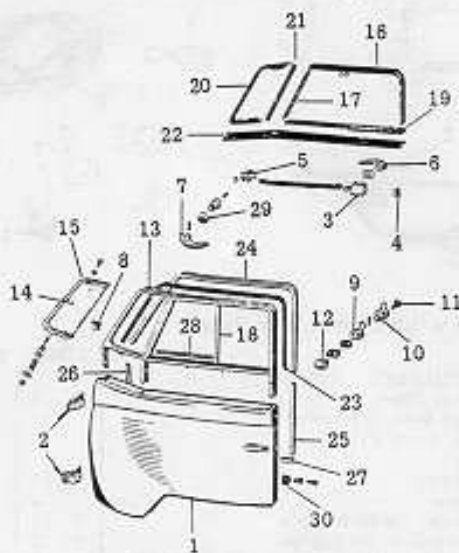

REMOVE & INSTALL:

Door	1.0
Door Window Frame Assy. *	.8

For GLASS, SEE Page C13.

CAB DOOR - ALL MODELS

	TIME	PRICE
1 DOOR SHELL, w/o Window Frame	3.5	42.60
2 Hinge	1.7	3.60
3 LOCK, Left	* 1.3	3.20
Right	* 1.3	4.05
4 Striker Plate, Lock	* .2	.25
5 Remote Control HANDLE		.95
6 Outside		
Locking	* .3	5.75
Non-Locking, To 1960	* .3	4.15
From 1960-	* .3	3.70
7 Inside, To 1959	* .2	1.10
From 1959-	* .2	1.60
8 Vent Fastener Assy. Handle Only	* 1.2	3.25
9 Sliding Glass, Fastener	.2	.70
10 Handle		.75
11 Screw		.75
12 Cover Plate		.55
13 FRAME, Door Window	O/H	2.0
14 VENT WINDOW, exc.	1.8	7.35
Delux Kombi	1.8	9.75
15 Frame, Vent Glass		5.40
GLASS RUN		
16 Upper & Rear	* .9	2.95
17 Front		.95
18 Center Bar, Metal		.40
19 Lower	* .9	1.65
WEATHERSTRIP		
20 Vent Window	1.8	3.25
21 Division		.20
22 Window Frame, Lower	* .8	.90
23 Outer		.80
24 Door, Upper	#	.5
25 Rear	#	.2
26 Front	#	.3
27 Lower	#	.5
* R&R All.	.9	
28 Guide Bar, Window		.30
29 Escutcheon, i.s. Handle		.10
30 Rubber Stop, Door		.10

* ARE FACTORY SUGGESTED ALLOWANCES
OTHER GLENN MITCHELL SUGGESTED.

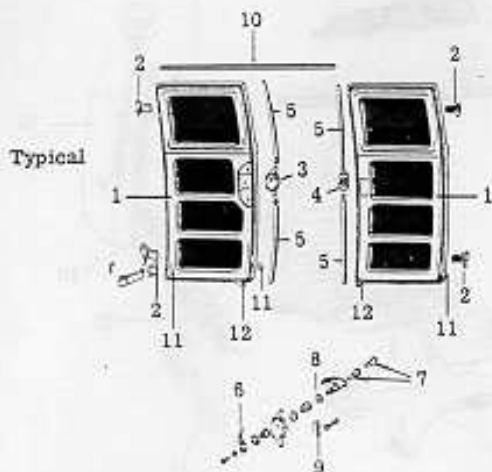

REMOVE & INSTALL DOOR ASSY. .6

For Bus or Kombi GLASS, SEE Page C13.

**LOADING DOOR
ALL MODELS**

	TIME	PRICE
1 DOOR SHELL		
Delivery Van		
To Mar. 1955	1.8	47.35
From Mar. 1955-	1.8	42.05
Micro Bus & Kombi		
To Mar. 1955	2.5	55.45
From Mar. 1955-	2.5	46.15
2 Hinge	* 2.5	2.80
LOCK		
3 Use w/o.s. Handle		
To Mar. 1955	* .6	8.15
From Mar. 1955-	* .6	6.30
4 Plunger Type, for i.s. Handle		
To Mar. 1955	* .6	1.95
From Mar. 1955-	* .6	2.30
5 CONTROL BARS, LOCK		.75
HANDLE		
Outside, Locking		
To Mar. 1955	* .2	2.50
Mar. 1955 To Aug. 1958	* .2	3.40
From Aug. 1958-	* .2	3.95
Inside, Painted	* .2	.95
Chrome	* .2	1.55
7 Cylinder w/Key	.3	2.00
8 Escutcheon, o.s. Handle		.60
9 Striker Plate	.2	.25
WEATHERSTRIP		
10 Upper, on Body	.3	2.55
11 Side, on Door	.3	2.60
12 Lower or Upper, on Door	.2	1.10

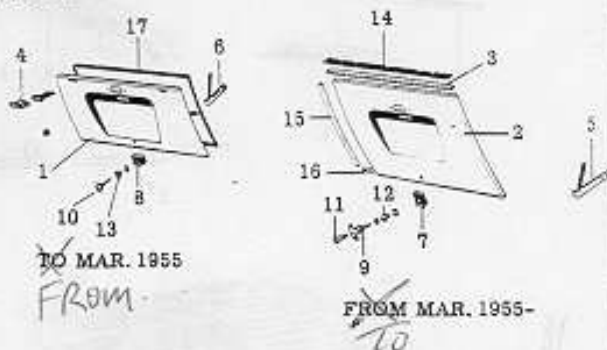

LID - ENGINE COMPARTMENT

	TIME	PRICE
1 LID, To Mar. 1955	* 1.3	30.50
From Mar. 1955-	* 1.3	21.60
2 Hinge, To Mar. 1955	* 2.2	1.70
From Mar. 1955-	* .5	1.70
Hinge Stay		
To Mar. 1955	* .4	.75
From Mar. 1955-	* .4	1.00
LOCK, Engine Compartment		
To Mar. 1955	* .4	2.00
From Mar. 1955-	* .4	2.15
HANDLE		
To Mar. 1955	.2	3.95
From Mar. 1955-		.80
11 Cylinder & Key, To Mar. 1955	.4	2.00
Escutcheon		
To Mar. 1955		.60
From Mar. 1955-		.90
14 Beading, To Mar. 1955		.35
WEATHERSTRIP		
15 To Mar. 1955, Side	* .5	1.50
16 From Mar. 1955-, Lower	* .5	1.80
17 From Mar. 1955-	.8	5.35

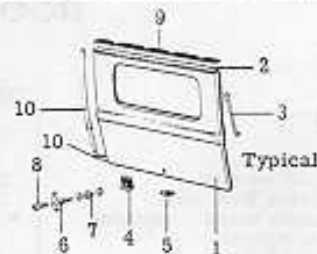

LID - REAR LOADING

1 LID, REAR LOADING		25.95
* R&R Type, w/o Window	* 1.2	
w/Window	1.7	
2 Hinge	* 2.2	2.00
3 Hinge Stay		1.20
4 LOCK, To Mar. 1955	* .4	2.15
From Mar. 1955-	* .4	3.00
5 Striker Plate	.2	.25
6 HANDLE, To Mar. 1955	.2	3.95
From Mar. 1955-	.2	5.25
7 Escutcheon, Handle		.60
8 Cylinder & Key	.4	1.50
9 Beading		.35
10 WEATHERSTRIP		
Side or Lower	* .5	1.70

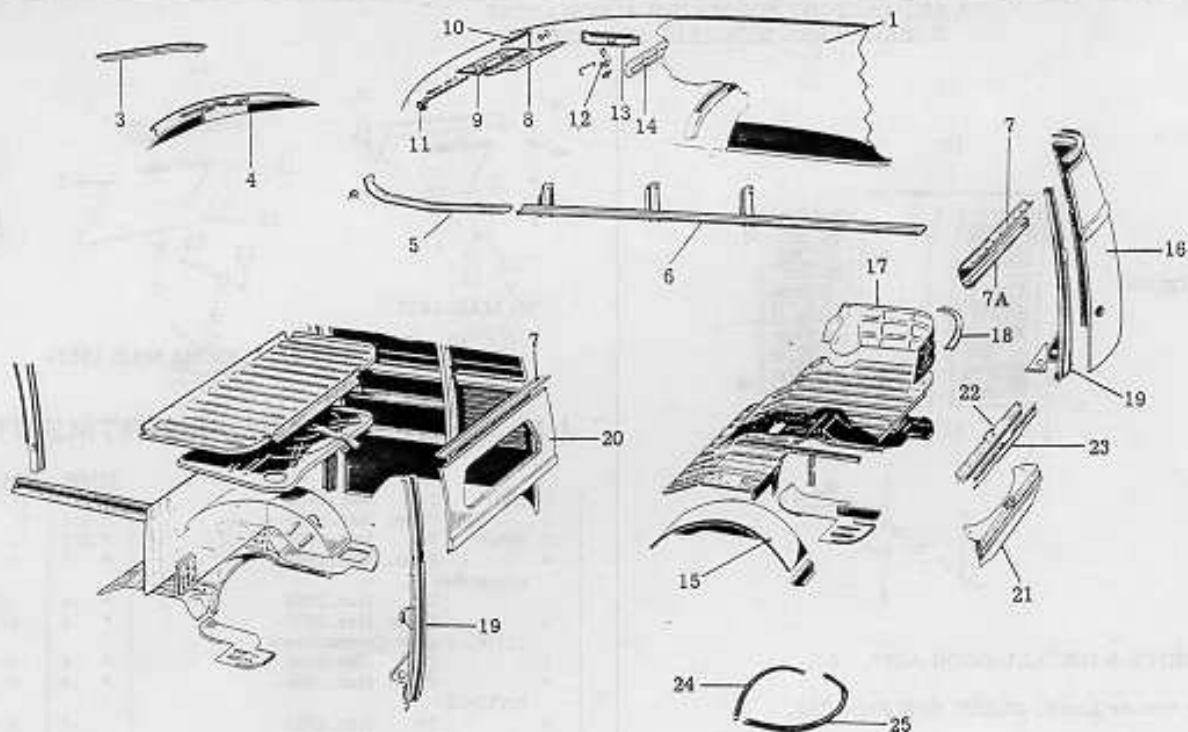

Inner Panel & Rail Time w/Outer Panels Removed.

ROOF & REAR BODY

	TIME	PRICE		TIME	PRICE
1 ROOF PANEL			WHEELHOUSE		
Van	25.0	97.15	15 Rear, Left	4.5	14.15
Micro Bus & Kombi			Right	5.0	16.65
w/o Sliding Roof	27.5	97.15	16 COVER PANEL		
w/Sliding Roof, exc.	32.0	148.55	Rear Outer, All exc.	*15.0	22.15
Delux Kombi w/Skylights	*33.5	169.75	Delux Kombi		43.85
Inner Panel, at Skylights			17 Inner		
Front, Left or Right	2.0	7.30	Right Side		4.70
Rear, Left or Right	2.0	9.15	Left Side		2.65
Frame					.75
3 Front, To Mar.1955	1.0	1.80	18 Connecting Plate		
4 From Mar.1955-	2.0	7.90	19 PILLAR, REAR CORNER		
5 Side, Front, above Cab Door	1.0	2.05	To Mar.1955	*	7.20
6 Rear, above Panels	1.5	5.05	From Mar.1955-	*	4.90
7 Rear, Center	1.0	1.60	* R&R w/o Outer Panel Removed,	7.0	
7A Cover Strip, Rear Frame		.95	w/Outer Panel Removed.	4.5	
AIR DUCT		12.75	REAR BODY PANEL		
8 Cover, Air Duct		1.05	20 Upper		
9 Shutter, Air Duct		2.40	All exc.		11.90
10 Gasket, Air Duct		.35	Delux Kombi		31.60
11 Handle, Shutter		.20	21 Lower		
12 Lever, Air Duct		.60	To Mar.1955	* .8	9.70
13 Flap, Air Duct		1.25	From Mar.1955-	* .8	10.35
14 Grille		.55	22 Crossmember, Rear		1.90
AIR SCOOP, To Mar.1955		48.35	23 Hinge Carrier, Rear Panel		2.60
Fly Screen, To Mar.1955		4.20	WEATHERSTRIP		
Distribution Box, To Mar.1955		23.70	24 Engine, Front Cover		.70
			25 Rear Cover		3.00

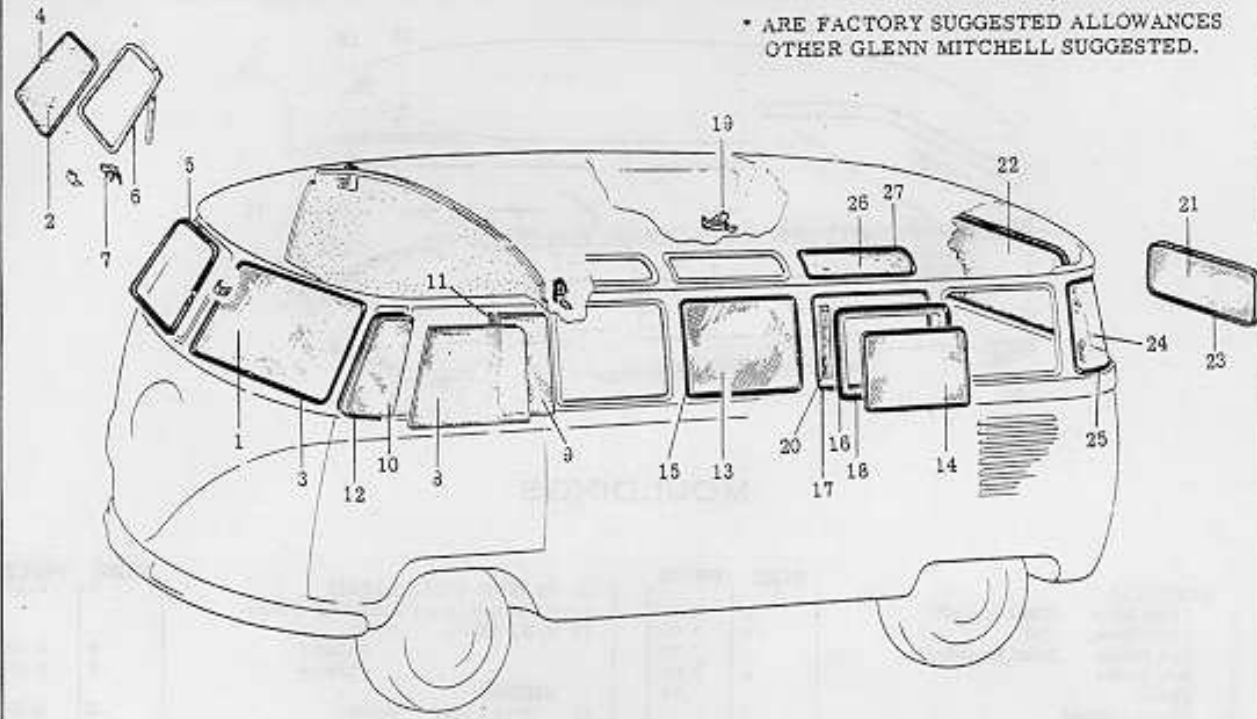

* ARE FACTORY SUGGESTED ALLOWANCES
OTHER GLENN MITCHELL SUGGESTED.

GLASS

			TIME	PRICE				TIME	PRICE
WINDSHIELD					BACK WINDOWS				
1	Glass		* .7	10.90	21	Glass, Van & Pick-Up.	Car Mfg. Glass Co.	* .5	6.00
2	Open-Out Type.	Car Mfg. Glass Co.	1.5	10.20	22	Micro Bus & Kombi	Car Mfg., exc. Delux Kombi Glass Co., exc. Delux Kombi	* .5 * .5 * .5 * .5	7.95 12.60
Weatherstrip					Weatherstrip				
3	Rubber Mounting, Windshield			2.45	23	Van & Pick-Up	Bus & Kombi		2.25 3.55
4	Open-Out Type			.70	CORNER WINDOW				
5	Windshield Frame			2.00	24	Glass, Laminated	Tempered	* 1.1 * 1.1	25.85 8.15
6	Frame, Open-Out Type W/S		1.5	11.10	25	Weatherstrip	* Car Mfg. Listing Only.		2.20
7	Fastener, Open-Out Type W/S			1.55	SKYLIGHT WINDOW				
DOOR GLASS - CAB					26	Glass, Laminated	Tempered	* .5 * .5	11.05 5.65
8	Glass, Sliding,	Car Mfg. * Glass Co. *	* 1.3 * 1.3	8.25	27	Weatherstrip	* Car Mfg. Listing Only.		1.95
9	Stationary,	Car Mfg. * Glass Co. *	* 1.3 * 1.3	4.50					
10	Vent Window,	Car Mfg. * Glass Co. *	.5 .3	4.15					
11	Weatherstrip, Door Glass			.25					
12	Vent			.25					
SIDE WINDOWS (Also used in Loading Doors)									
13	Glass, Stationary Type,	Car Mfg. * Glass Co. *	* .5 * .5	7.65					
14	Open-Out Type,	Car Mfg. * Glass Co. *	* .5 * .6	6.60					
Weatherstrip									
15	Stationary Type			2.10					
16	Open-Out Type,	Glass		.70					
17	Frame		.5	1.20					
18	Frame, Open-Out Window			5.90					
19	Fastener, Window, exc.		.2	4.50					
20	Hinge	Wide Opening	.2	5.40					
				.35					

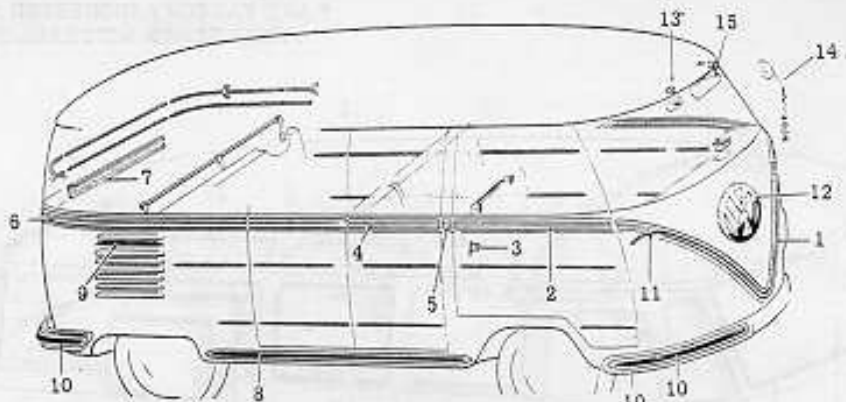

MOULDINGS

MOULDING	TIME	PRICE		TIME	PRICE
1 Front Body, Right or Left	1.0	4.30	11 PLASTIC FILLER STRIP	.2	3.10
2 Front Door, Cab	.8	3.65	* For use in All Mouldings Listed.		
3 End Piece, Door Moulding		.30	12 V.W. SIGN, Front	.8	3.20
4 Side Doors	.6	2.00	Painted	.8	9.95
5 Pillar		.80	Chrome		
6 Quarter Panel			MIRROR		
Left	1.0	9.45	13 Rear View, Inside	.2	3.15
Right	.8	6.30	14 Outside	.2	4.30
7 Rear Panel, Upper	.6	3.00	15 SUN VISOR	.2	3.00
8 Rocker Panel	.7	7.30	Van	.2	4.75
9 Louvers	.2	.25	Bus & Kombi, exc.	.2	7.90
10 Bumpers - SEE Page C1.			w/ Rear View Mirror	.2	

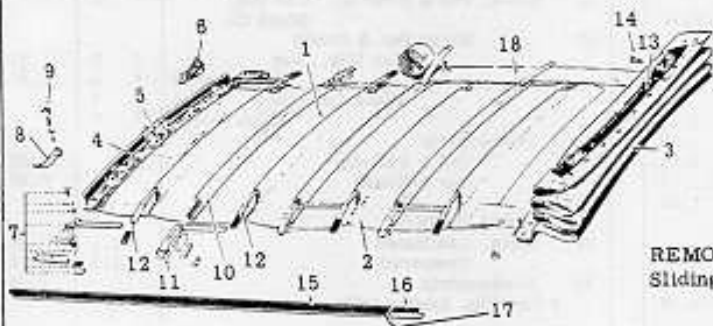

REMOVE & INSTALL Complete Sliding Roof & Guide Rails. * 4.0

SLIDING ROOF

1 HOOPS w/ LINING	* 4.0	134.00
2 Lining Only	4.5	25.05
3 COVER, Outer	* 2.0	48.00
4 LOCKING BOW w/ LOCK	2.0	41.25
5 Lock Only	1.0	10.00
6 Tensioner		2.35
7 Plate Assy.		5.05
* HANDLE	.3	1.75
9 Escutcheon		.75
10 Guide Hoop		4.45
11 Tension Hoop, Front		2.45
13 LOCKING CHANNEL	1.5	8.50
14 Mounting Pin, Channel		.15
GUIDE BAR		
15 Front	* 1.3	6.60
16 Rear		.75
17 Beading, Guide Bar		.70
18 Strap, Side		3.35



SEAT CLAMPS

1 SUPPORT, Seat Mounting		.60
2 Clamp, Support		.25
3 "T" Head Bolt		.30

1952 - TO DATE

2-62

VOLKSWAGEN - COMMERCIAL

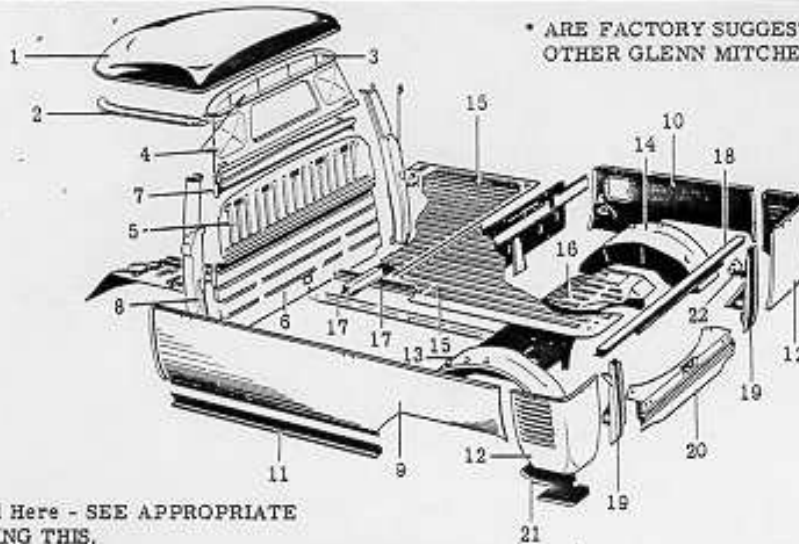

* ARE FACTORY SUGGESTED ALLOWANCES
OTHER GLENN MITCHELL ESTIMATED.

For Parts Not Listed Here - SEE APPROPRIATE
SECTION PRECEDING THIS.

PICK-UP

	TIME	PRICE		TIME	PRICE
1 ROOF	11.0	41.10	13 WHEELHOUSE PANEL		
2 Frame, Roof, Side	1.5	2.00	14 Left	5.0	14.10
3 Reinforcement, Cab Rear		4.25	14 Right	5.0	16.65
CAB, BACK PANEL			FLOOR PANELS		
4 Upper w/ Roof Rail		16.55	15 Front or Rear Loading		42.25
5 Center		12.25	16 Engine		13.95
6 Lower		14.70	FLOOR RAIL		
7 Reinforcement, Cab Back		12.25	17 Side, Inner or Outer		12.95
8 LOCK PILLAR, Cab Door	6.0	17.70	18 Rear		10.75
PICK-UP BED			19 PILLAR, Rear Body	3.5	3.25
9 SIDE PANEL, used w/o Loading Gate	13.5	37.65	20 PANEL, Rear	1.5	10.85
10 SIDE PANEL, used w/ Loading Gate	10.5	22.90	21 Cover Plate, Engine Side	1.5	5.40
11 Reinforcement, Lower		3.25	22 Bracket, Lids		.55
12 CORNER PANEL, Rear	7.5	18.70			

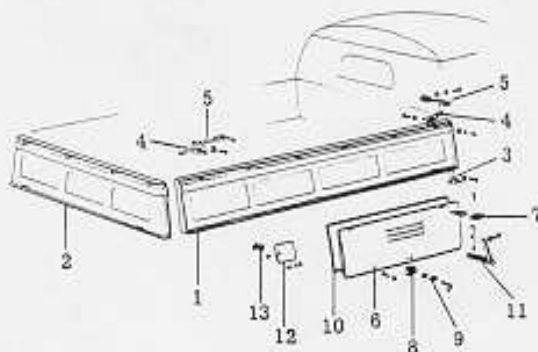

	TIME	PRICE
LOADING GATE		
1 Side	* .8	63.15
2 Rear	* .8	50.75
3 Hinge, Loading Gate	* 1.0	3.60
4 Eye, Gate Hook	* .4	1.25
5 Hook	* .6	3.70
SIDE PANEL LID		
6 SIDE PANEL LID	* 1.3	30.85
7 Hinge, Side Lid	* .5	2.95
8 Lock, Side Lid	.5	5.40
9 Escutcheon		1.15
10 Weatherstrip, Side Lid	.7	6.20
11 Stay, Side Lid	.3	1.80
COVER, Gas Lid		
12 COVER, Gas Lid	.3	2.80
Weatherstrip		.30
13 Lock		2.00

LID, Engine Compartment - SEE Page C11.